

WOODLAND WALK

Designed by Elise Lea for RK
www.robertkaufman.com

Featuring **Santa's
Woodland Walk**



Finished quilt measures: 52" x 64"









Difficulty Rating: **Beginner**

ROBERTKAUFMAN
F A B R I C S

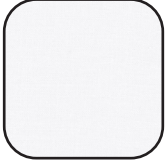
For questions about this pattern, please email Patterns@RobertKaufman.com.

Fabric and Supplies Needed

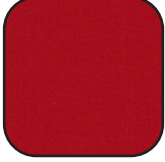
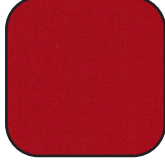
Fabric amounts based on yardage that is 42" wide.

Color	Fabric	Name/SKU	Yardage	Color	Fabric	Name/SKU	Yardage
	A	AUND-21117-277 WINTER	1 yard (one full panel)		F	K001-1083 COFFEE	1/8 yard
	B	K001-1387 WHITE	5/8 yard		G	AUND-21122-87 SNOW	1 yard
	C	AUND-21118-63 SKY	1/2 yard		H	AUND-21119-87 SNOW	1-2/3 yards
	D	K001-1551 RICH RED	1/3 yard		Binding*	K001-1551 RICH RED <small>*Also used for Fabric D</small>	1/2 yard
	E	AUND-21121-224 EVERGREEN	1/4 yard	You will also need: 3-3/8 yards for backing			

Copyright 2022, Robert Kaufman
For individual use only - Not for resale

Notes Before You Begin

- Read through all of the instructions before beginning.
- All of the seam allowances are 1/4" unless otherwise noted.
- Press seam allowances open unless otherwise noted.
- Width of fabric (WOF) is equal to at least 42" wide.
- Right sides together has been abbreviated to RST.
- Remember to measure twice and cut once!

Cutting Instructions

From Fabric A, fussy cut:

four 15-1/2" squares

From Fabric B, cut:

one 3-1/4" x WOF strip. Subcut:

nine 3-1/4" squares for the Flying Geese

four 1-1/2" x WOF strips. Subcut:

eight 1-1/2" x 16-1/2" strips

four 1-1/2" squares

eight 1" x WOF strips. Subcut:

eight 1" x 15-1/2" strips for the side Block borders

eight 1" x 16-1/2" strips for the top/bottom Block borders

From Fabric C, cut:

one 15" x WOF strip. Subcut:

six 2-1/2" x 15" strips. Trim each strip to 14-1/2" long for the vertical Sashing.

Trim the remainder of the fabric into:

six 2-1/2" x 14-1/2" strips, for the horizontal Sashing, following the cutting diagram

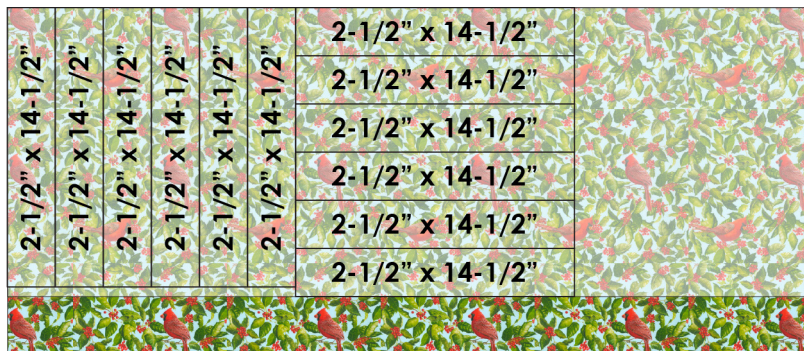

From Fabric D, cut:

one 2-1/2" x WOF strip. Subcut:

nine 2-1/2" squares for the Cornerstones

four 1-7/8" x WOF strips. Subcut:

seventy-two 1-7/8" squares for the Flying Geese

From Fabric E, cut:

four 2" x WOF strips. Subcut:

ten 2" x 6-1/2" rectangles

ten 2" x 5" rectangles

ten 2" x 3-1/2" rectangles

From Fabric F, cut:

one 2" x WOF strip. Subcut:

ten 1-1/2" x 2" rectangles for the tree trunks

From Fabric G, cut:

one 6-1/2" x WOF strip. Subcut:

four 3-1/2" x 6-1/2" rectangles for the Tree Row Ends

eight 2-1/2" x 6-1/2" rectangles for the Tree Sashing

five 2-1/2" x WOF strips. Sew together, end-to-end, then trim:

two 2-1/2" x 40-1/2" side inner borders

two 2-1/2" x 44-1/2" top/bottom inner borders

eight 2" x WOF strips. Subcut:

twenty 2" x 3" rectangles

twenty 2" x 1-1/4" rectangles

eighty 2" squares. Mark a diagonal line on the back of each square.

From Fabric H, cut:

two 4-1/2" x length of fabric strips. Trim to:

two 4-1/2" x 56-1/2" side outer borders

From the remainder of the fabric, cut:

four 4-1/2" x WOF strips. Sew together, end-to-end, then trim:

From the Binding, cut:

six 2-1/2" x WOF strips.

Assemble the Flying Geese

Step 1: Pin two 1-7/8" Fabric D squares in opposing corners of a 3-1/4" Fabric B square, RST. The squares will overlap slightly in the center of the large square. Using a ruler, draw a diagonal line through the squares.



Step 2: Sew scant 1/4" seam on each side of the diagonal line. Set the seam by pressing it flat. Cut along the diagonal line, creating two identical units.



Step 3: Press the fabric toward smaller triangles. Repeat with the second unit.



Step 4: Place one 1-7/8" Fabric D square at the corner of sewn block unit. Draw diagonal line in pencil. Sew a scant 1/4" seam on each side of diagonal line. Set seam (press). Cut along diagonal line, creating two identical units.



Step 5: Press the seam toward smaller triangle. Trim off small dog ears left by the seam allowance. Trim to 1-1/2" x 2-1/2" if necessary. Repeat to make four flying geese blocks.



Step 6: Repeat with all remaining 1-7/8" Fabric B squares and 3-1/4" Fabric D squares to make a total of thirty-six flying geese blocks.

Assemble the Quilt Center



Step 7: Sew a 1" x 15-1/2" Fabric B strip to the left and right edges of a Fabric A square. Press toward the strips. Sew a 1" x 16-1/2" Fabric B strip to the top and bottom edges of the unit. Press toward the strips. Repeat to make four Blocks like this.

Step 8: Sew a completed Step 5 Flying Geese unit to each end of a Fabric C sashing strip. Repeat for all twelve Fabric C strips. Press toward the strips.

Step 9: Sew the Fabric D squares, Step 7 Blocks and Step 8 units together in five rows of five, as shown. Press the seams away from the Step 8 units.

Step 10: Sew two 1-1/2" x 16-1/2" Fabric B strips and three Flying Geese units together to form the left side border of the Quilt Center. Sew to the left of the Quilt Center. Press. Repeat for the right side of the Quilt Center.

Step 11: Sew two 1-1/2" x 16-1/2" Fabric B strips, three Flying Geese units and two 1-1/2" Fabric B squares together to form the top border of the Quilt Center. Sew to the top of the Quilt Center. Press. Repeat for the bottom of the Quilt Center.

Assemble the Tree Blocks

Step 11: Place a 2" Fabric G square on the left edge of a 2" x 3-1/2" Fabric E rectangle, right sides together. Note the orientation of the marked diagonal line. Sew on the marked line, then trim away the excess fabric, leaving a 1/4" seam allowance. Press. Repeat on the right edge with another 2" Fabric G square. Sew a 2" Fabric G square to the left and right edges of the unit. Press. Make ten units like this.

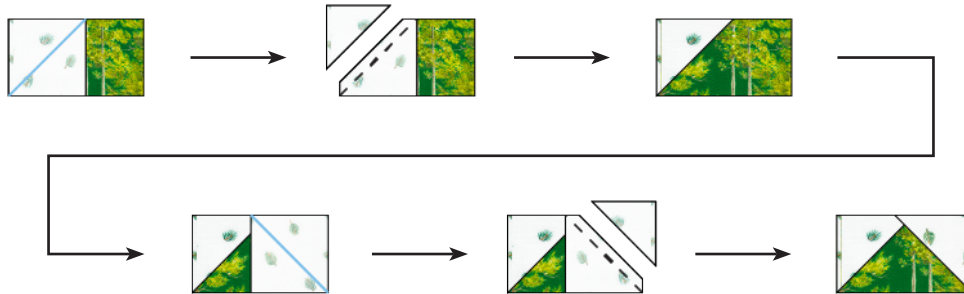

Step 12: Repeat the process from Step 11 with each 2" x 5" Fabric E rectangle, first sewing a 2" Fabric G square along the marked lines, trimming and pressing, then sewing a 2" x 1-1/4" Fabric G rectangle to the left and right edges, as shown. Press. Make ten units like this.

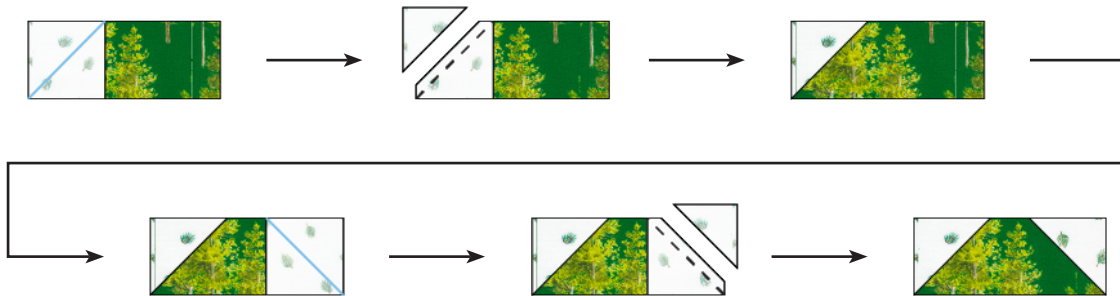

Step 13: Repeat the process from Step 11 with each 2" x 6-1/2" Fabric E rectangle. Press. Make ten units like this.

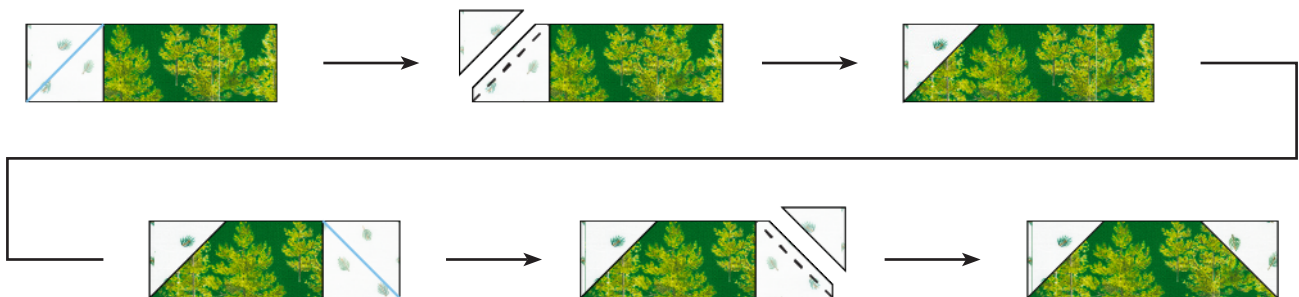

Step 14: Sew a 2" x 3" Fabric G rectangle to the left and right edges of a Fabric F rectangle. Press. Make ten units like this.



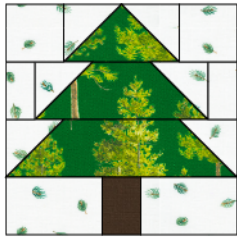

Step 15: Gather:
 one completed Step 11 unit
 one completed Step 12 unit
 one completed Step 13 unit
 one completed Step 14 unit

Arrange the units into four rows. Note the fabric placement and unit orientation in the Block Assembly Diagram.

Step 16: Sew the rows together, pressing the seams to one side to form the block. The resulting Tree Block should measure 6-1/2" square. Make ten Tree Blocks

Step 17: Sew five Tree Blocks together, placing a 2-1/2" x 6-1/2" Fabric G rectangle between each block and a 3-1/2" x 6-1/2" Fabric G rectangle at each end of the row. Press toward the G rectangles. Make two rows like this.

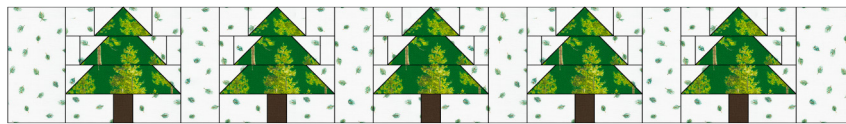

Assemble the Quilt



Step 18: Sew the Fabric G side inner borders to the left and right edges of the Quilt Center. Press.

Step 19: Sew the Tree Rows to the top and bottom edges of the Quilt Center, noting the orientation. Press.

Step 20: Sew the Fabric G top/bottom inner borders to the top and bottom edges of the Quilt Center. Press.

Step 21: Sew the side outer borders to the sides of the quilt center. Press toward the borders. Sew the top and bottom outer borders to the quilt center. Press toward the borders.

Your quilt top is complete. Baste, quilt, bind and enjoy!