

STAR CROSSED

Designed by Elise Lea for RK
www.robertkaufman.com

Featuring **KONA**[®]
cotton solids



2023
KONA[®]
cotton solids
365
CALENDAR
QUILT

Finished quilt measures: 72" x 84"







Difficulty Rating: **Intermediate**

ROBERTKAUFMAN
F A B R I C S

For questions about this pattern, please email Patterns@RobertKaufman.com.

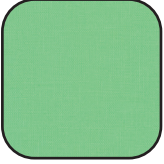
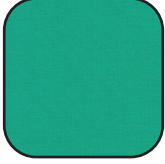
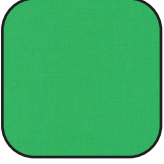
Fabric and Supplies Needed

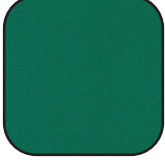
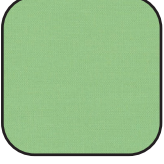
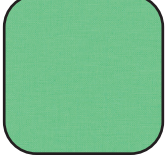
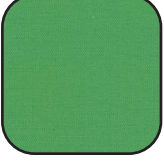
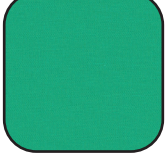
Fabric amounts based on yardage that is 42" wide.

Color	Fabric	Name/SKU	Yardage	Color	Fabric	Name/SKU	Yardage
	A	K001-1387 WHITE	1-7/8 yards		H	K001-1185 KELLY	5/8 yard
	B	K001-356 EVERGLADE	3/4 yard		I	K001-221 PARAKEET	5/8 yard
	C	K001-1031 BLUEGRASS	3/4 yard		J	K001-1141 FERN	3/4 yard
	D	K001-483 ULTRA MARINE	3/4 yard		K	K001-136 BASIL	5/8 yard
	E	K001-1388 WILLOW	5/8 yard		L	K001-29 SPRING	5/8 yard
	F	K001-1842 FERNDALE	5/8 yard		M	K001-28 LEAF	3/4 yard
	G	K001-445 KALE	3/4 yard		Binding	K001-1135 EMERALD	5/8 yard
<p>Copyright 2022, Robert Kaufman For individual use only - Not for resale</p>				<p>You will also need: 5-1/8 yards for backing</p>			

Notes Before You Begin

- Read through all of the instructions before beginning.
- All of the seam allowances are 1/4" unless otherwise noted.
- Press seam allowances open unless otherwise noted.
- Width of fabric (WOF) is equal to at least 42" wide.
- Right sides together has been abbreviated to RST.
- Remember to measure twice and cut once!

Cutting Instructions

From Fabric A, cut

two 6-1/2" x WOF strips. Subcut:
 nine 6-1/2" squares.
 three 3-1/2" x 6-1/2" rectangles.
seven 4" x WOF strips. Subcut:
 sixty-six 4" squares.
seven 3-1/2" x WOF strips. Subcut:
 seventy-eight 3-1/2" squares.

From Fabric B, cut:

two 4" x WOF strips. Subcut
 twelve 4" squares.
five 3-1/2" x WOF strips. Subcut:
 twenty-four 3-1/2" x 6-1/2" rectangles.
 twelve 3-1/2" squares.

From Fabric C, cut:

two 4" x WOF strips. Subcut
 eighteen 4" squares.
five 3-1/2" x WOF strips. Subcut:
 twelve 3-1/2" x 6-1/2" rectangles.
 thirty-six 3-1/2" squares.

From Fabric D, cut:

three 4" x WOF strips. Subcut
 thirty 4" squares.
three 3-1/2" x WOF strips. Subcut:
 thirty-six 3-1/2" squares.

From each of Fabrics E, H, and K, cut:

one 4" x WOF strip. Subcut
 seven 4" squares.
four 3-1/2" x WOF strips. Subcut:
 eighteen 3-1/2" x 6-1/2" rectangles.
 ten 3-1/2" squares.

From each of Fabrics F, I, and L, cut:

two 4" x WOF strips. Subcut
seventeen 4" squares.
four 3-1/2" x WOF strips. Subcut:
nine 3-1/2" x 6-1/2" rectangles.
twenty-eight 3-1/2" squares.

From each of Fabrics G, J, and M, cut:

three 4" x WOF strips. Subcut
twenty-six 4" squares.
three 3-1/2" x WOF strips. Subcut:
twenty-eight 3-1/2" squares.

From the Binding Fabric, cut:

nine 2-1/2" x WOF strips.

Assemble the Flying Geese

Step 1: Place a 3-1/2" Fabric A square on one end of a 3-1/2" x 6-1/2" Fabric B rectangle, RST. Mark a diagonal line on the square as shown. Sew on the marked line, then trim the excess fabric away leaving a 1/4" seam allowance. Press.

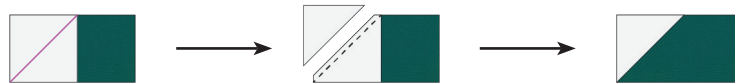

Step 2: Repeat to add a second 3-1/2" Fabric A square to the opposite end of the unit. Trim to 3-1/2" x 6-1/2" if necessary.

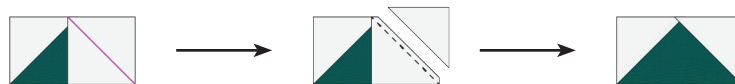

Repeat to make the quantities each fabric combination shown below.



Make twelve
B/A flying geese.



Make twelve
B/C flying geese.



Make twelve
C/D flying geese.



Make nine
E/A flying geese.



Make nine
E/F flying geese.

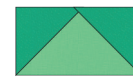

Make nine
F/G flying geese.



Make nine
H/A flying geese.



Make nine
H/I flying geese.



Make nine
I/J flying geese.

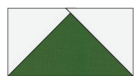

Make nine
K/A flying geese.

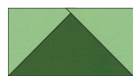

Make nine
K/L flying geese.

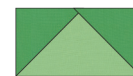

Make nine
L/M flying geese.

Assemble the Half-Square Triangles (HSTs)

Step 3: Pair a 4" Fabric B square with a 4" Fabric C Square, RST. Mark a diagonal line on the wrong side of one square. Sew 1/4" away from both sides of the marked line. Cut on the marked line, creating two half-square triangles (HSTs). Press toward the darker fabric. Trim to 3-1/2" square. Repeat to make twelve B/C HSTs.



Step 4: Repeat to make the quantities each fabric combination shown below.



Make twenty-four
C/D HSTs.



Make thirty-six
D/A HSTs.



Make twelve
E/F HSTs.



Make twenty-two
F/G HSTs.



Make thirty
G/A HSTs.



Make two
E/A HSTs.



Make twelve
H/I HSTs.



Make twenty-two
I/J HSTs.



Make thirty
J/A HSTs.



Make two
H/A HSTs.



Make twelve
K/L HSTs.



Make twenty-two
L/M HSTs.



Make thirty
M/A HSTs.



Make two
K/A HSTs.

Assemble the Blocks

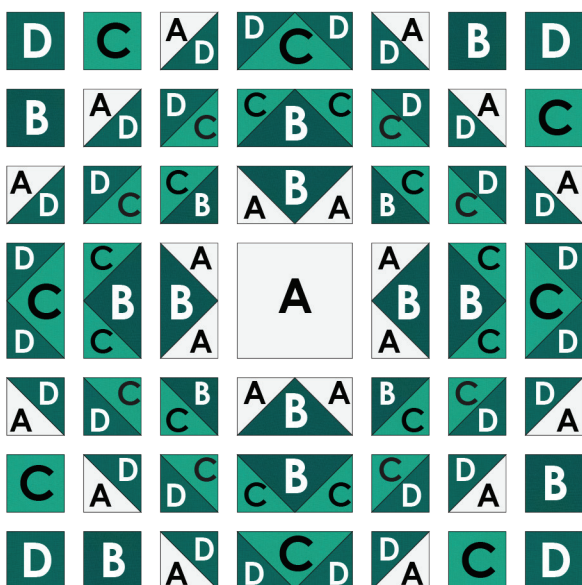

Step 5: Gather:

- one 6-1/2" Fabric A square
- four B/A flying geese
- four B/C flying geese
- four C/D flying geese
- four B/C HSTs
- eight C/D HSTs
- twelve D/A HSTs
- four 3-1/2" Fabric B squares
- four 3-1/2" Fabric C squares
- four 3-1/2" Fabric D squares

Arrange the units into seven rows as shown. Note the fabric placement and orientation on the block diagram.

Step 6: Sew the units together to form the rows. Press the seams of each row in opposite directions.

Step 7: Sew the rows together, nesting the seams and pressing the seams to one side to form the block.

Step 8: Repeat the steps above using the fabric combinations to create the quantity of blocks listed below.

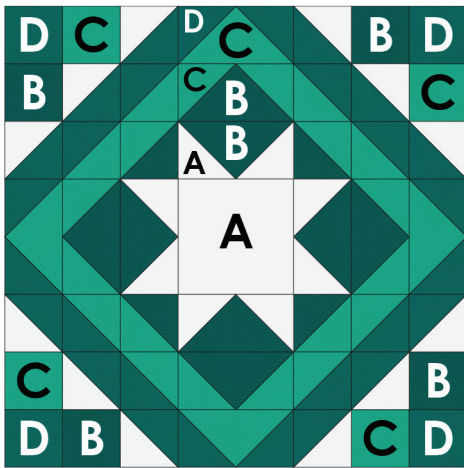

Make three A/B/C/D blocks.

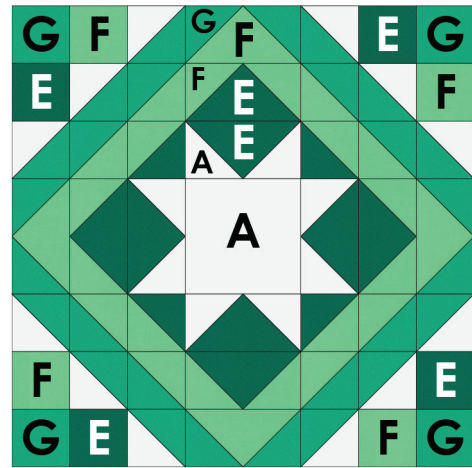

Make two A/E/F/G blocks.

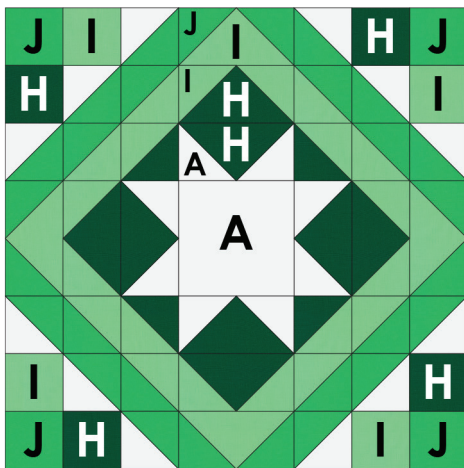

Make two A/H/I/J blocks.

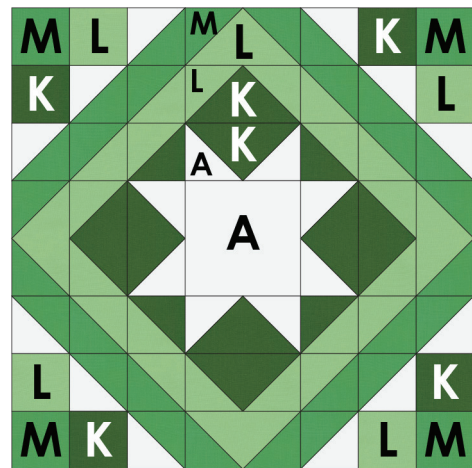

Make two A/K/L/M blocks.

Assemble the Half-Blocks

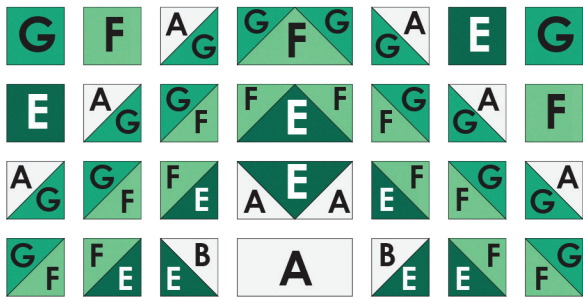

Step 9: Gather:

- one 3-1/2" x 6-1/2" Fabric A rectangle
- one E/A flying geese
- one E/F flying geese
- one F/G flying geese
- four E/F HSTs
- six F/G HSTs
- six G/A HSTs
- two E/A HSTs
- two 3-1/2" Fabric E squares
- two 3-1/2" Fabric F squares
- two 3-1/2" Fabric G squares

Arrange the units into four rows as shown. Note the fabric placement and orientation on the block diagram.

Step 10: Sew the units together to form the rows. Press the seams of each row in opposite directions.

Step 11: Sew the rows together, nesting the seams and pressing the seams to one side to form the half-block.

Step 12: Repeat the steps above using the fabric combinations to create the quantity of half-blocks listed below.



Make one A/E/F/G half-block.

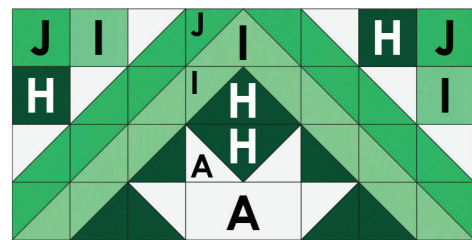

Make one A/H/I/J half-block.



Make one A/K/L/M half-block.

Assemble the Quilt

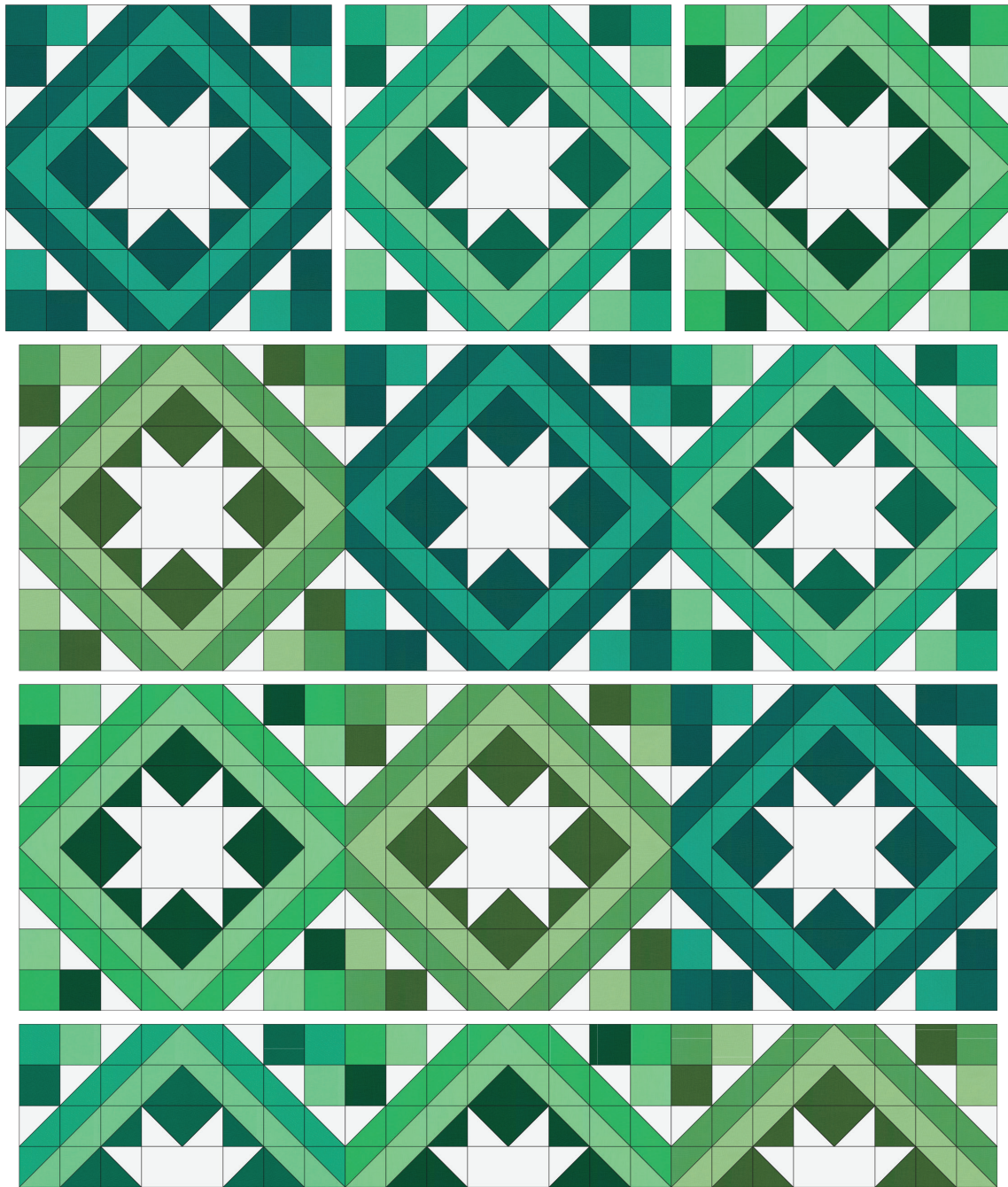

Step 13: Arrange the Blocks and Half-Blocks in rows as shown on the Quilt Assembly Diagram.

Step 14: Sew the Blocks together to form the rows. Press the seams of the odd-numbered rows to the right and the seams of the even-numbered rows to the left.

Step 15: Nest the seams and sew the rows together. Press.

Your quilt top is complete! Baste, quilt, bind, and enjoy!

This pattern may be used for personal purposes only and may not be reproduced in any form without the express permission from Robert Kaufman Fabrics. This pattern is not for resale. All patterns, unless otherwise attributed, are © Robert Kaufman Co., Inc. 2005-2022. All rights reserved.