

RIBBONS

Designed by Elise Lea
www.robertkaufman.com

Featuring FLOWERHOUSE

1930's **Basics**
A FLOWERHOUSE COLLECTION
by Debbie Beaves

Ten Square
Friendly



Finished quilt measures: 59" x 71-1/2"





Difficulty Rating: **Intermediate**

ROBERTKAUFMAN
F A B R I C S

For questions about this pattern, please email Patterns@RobertKaufman.com.

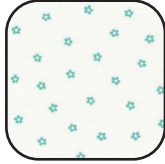
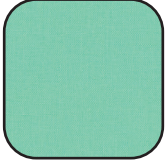
Fabric and Supplies Needed

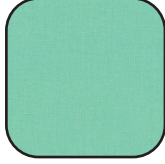
Fabric amounts based on yardage that is 42" wide.

Color	Fabric	Name/SKU	Yardage	Color	Fabric	Name/SKU	Yardage
		TEN-1130-42 1930'S BASICS	One Ten Square Pack		D	FLH-21505-36 ALOE	1/3 yard
	A	K001-197 ALOE	1/4 yard		E	FLH-21221-36 ALOE	5/8 yard
	B	FLH-21227-36 ALOE	2-1/4 yards		Binding*	K001-197 ALOE	1/2 yard
	C	FLH-21221-36 ALOE	5/8 yard			<i>*Also used for Fabric A</i>	
Copyright 2022, Robert Kaufman For individual use only - Not for resale				You will also need: 3-3/4 yards for backing			

Notes Before You Begin

- Read through all of the instructions before beginning.
- All of the seam allowances are 1/4" unless otherwise noted.
- Press seam allowances open unless otherwise noted.
- Width of fabric (WOF) is equal to at least 42" wide.
- Right sides together has been abbreviated to RST.
- Remember to measure twice and cut once!

Cutting Instructions

From the squares in the Ten Square Pack, cut:

up to six 1-1/2" x WOF strips from each square. A total of 128 strips are needed.

From each strip, subcut:

two 1-1/2" x 3-1/2" rectangles

one 1-1/2" squares

From Fabric A, cut:

three 2" x WOF strips. Subcut:

forty-eight 2" squares.

From Fabric B, cut:

eleven 3-1/2" x WOF strips. Subcut:

one-hundred and twenty-eight 3-1/2" squares.

twenty-six 1-1/2" x WOF strips. Subcut:

one-hundred and twenty-eight 1-1/2" x 3-1/2" rectangles.

four-hundred and sixteen 1-1/2" squares.

From Fabric C, cut:

two 10" x WOF strips. Subcut:

eight 10" squares.

Subcut seven of the squares once diagonally to yield fourteen setting triangles.

Subcut one of the squares twice diagonally to yield four corner setting triangles.

From Fabric D, cut:

six 1-1/2" x WOF strips. Sew the strips together end-to-end, then trim:

two 1-1/2" x 64-1/2" side inner borders.

two 1-1/2" x 53-1/2" top/bottom inner borders.

From Fabric E, cut:

six 3-1/2" x WOF strips. Sew the strips together end-to-end, then trim:

two 3-1/2" x 66-1/2" side outer borders.

two 3-1/2" x 59-1/2" side top/bottom borders.

From the Binding Fabric, cut:

seven 2-1/2" x WOF strips.

Assemble the A Blocks

Step 1: Gather:

thirteen 1-1/2" Fabric B squares

four 1-1/2" x 3-1/2" Fabric B rectangles

four 3-1/2" Fabric B squares

four sets of Ten Square pieces (one 1-1/2" square and two 1-1/2" x 3-1/2" rectangles per set)

Step 2: Place a 1-1/2" Fabric B square on one end of a 1-1/2" x 3-1/2" Ten Square rectangle. Mark a diagonal line on the square, then sew on the drawn line. Trim the seam allowance 1/4" from the sewn seam. Press.

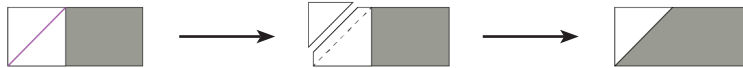

Step 3: Place a 1-1/2" Fabric B square on one end of the other 1-1/2" x 3-1/2" Ten Square rectangle from the same set. Mark a diagonal line on the square, then sew on the drawn line. Notice how the line is angled opposite of the direction in Step 2. Trim the seam allowance 1/4" from the sewn seam. Press. Repeat to add a Fabric B square to each Ten Square rectangle you gathered.

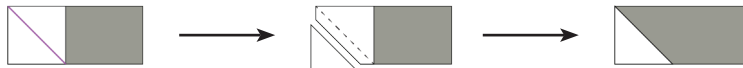

Step 4: Arrange all of the pieces you gathered in five rows as shown. Notice how the pieces from each set are in line with one another.

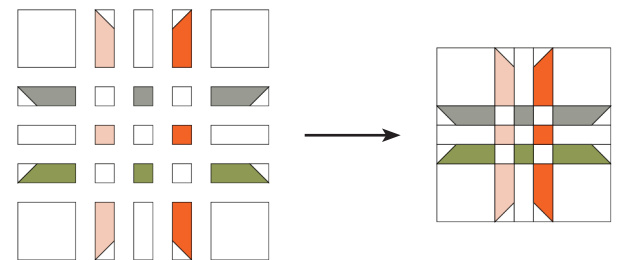

Step 5: Sew the pieces together to form rows. Press the seams towards the Fabric B squares and rectangles.

Step 6: Nest the seams and sew the rows together. Make thirty-two blocks.
Note: Twelve of the A Blocks will be used to create the B Blocks.

Note: Twelve of the A Blocks will be used to create the B Blocks.

Assemble the B Blocks

Step 7: Gather:
four 2" Fabric A squares
one A Block

Step 8: Place a 2" Fabric A square on each corner of an A Block. Mark a diagonal line on the square, then sew on the drawn line. Trim the seam allowance 1/4" from the sewn seam. Press. Make twelve B Blocks.

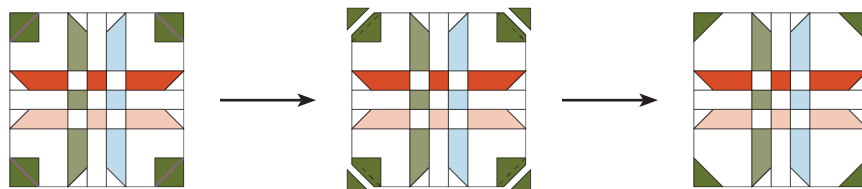

Assemble the Quilt

Step 9: Arrange the blocks into diagonal rows as shown in the Quilt Assembly Diagram. Notice how the A and B blocks alternate across the quilt top. Add a setting triangle to the ends of the rows.

Step 10: Sew the blocks together to form rows. Press the seams in the odd-numbered rows to the left and the seams in the even-numbered rows to the right.

Step 11: Sew the rows together to form the quilt center. Press the row seams open.

Step 12: Sew the side inner borders to the sides of the quilt center. Press toward the borders. Sew the top and bottom inner borders to the quilt center. Press toward the borders.

Step 13: Sew the side outer borders to the sides of the quilt center. Press toward the borders. Sew the top and bottom outer borders to the quilt center. Press toward the borders.

Your quilt top is complete! Baste, quilt, bind, and enjoy!

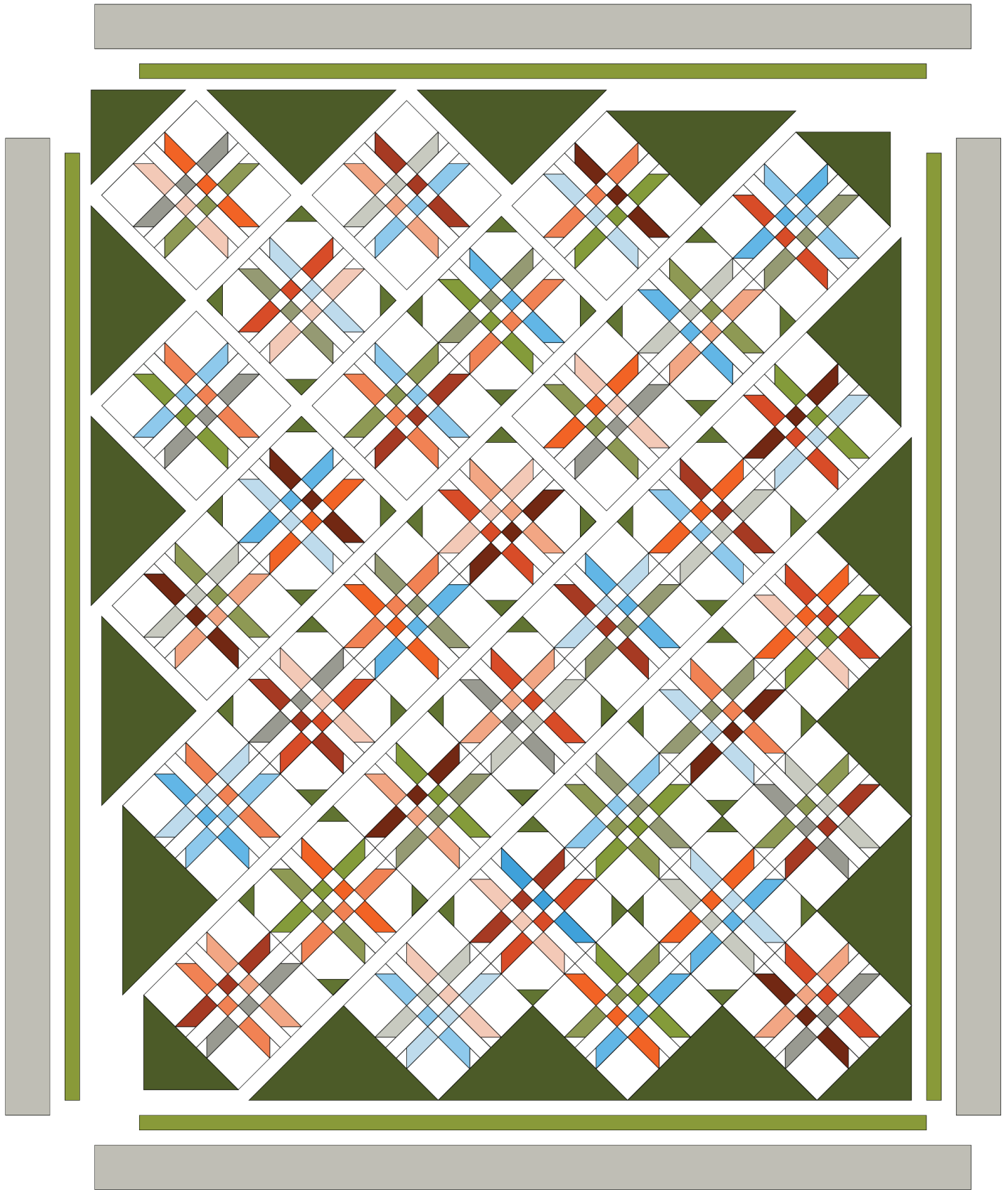

This pattern may be used for personal purposes only and may not be reproduced in any form without the express permission from Robert Kaufman Fabrics. This pattern is not for resale. All patterns, unless otherwise attributed, are © Robert Kaufman Co., Inc. 2005-2022. All rights reserved.