

OUTLINED

Designed by Elise Lea for RK
www.robertkaufman.com

Featuring

KONA[®] 2021 COLOR
OF THE
cotton solids YEAR

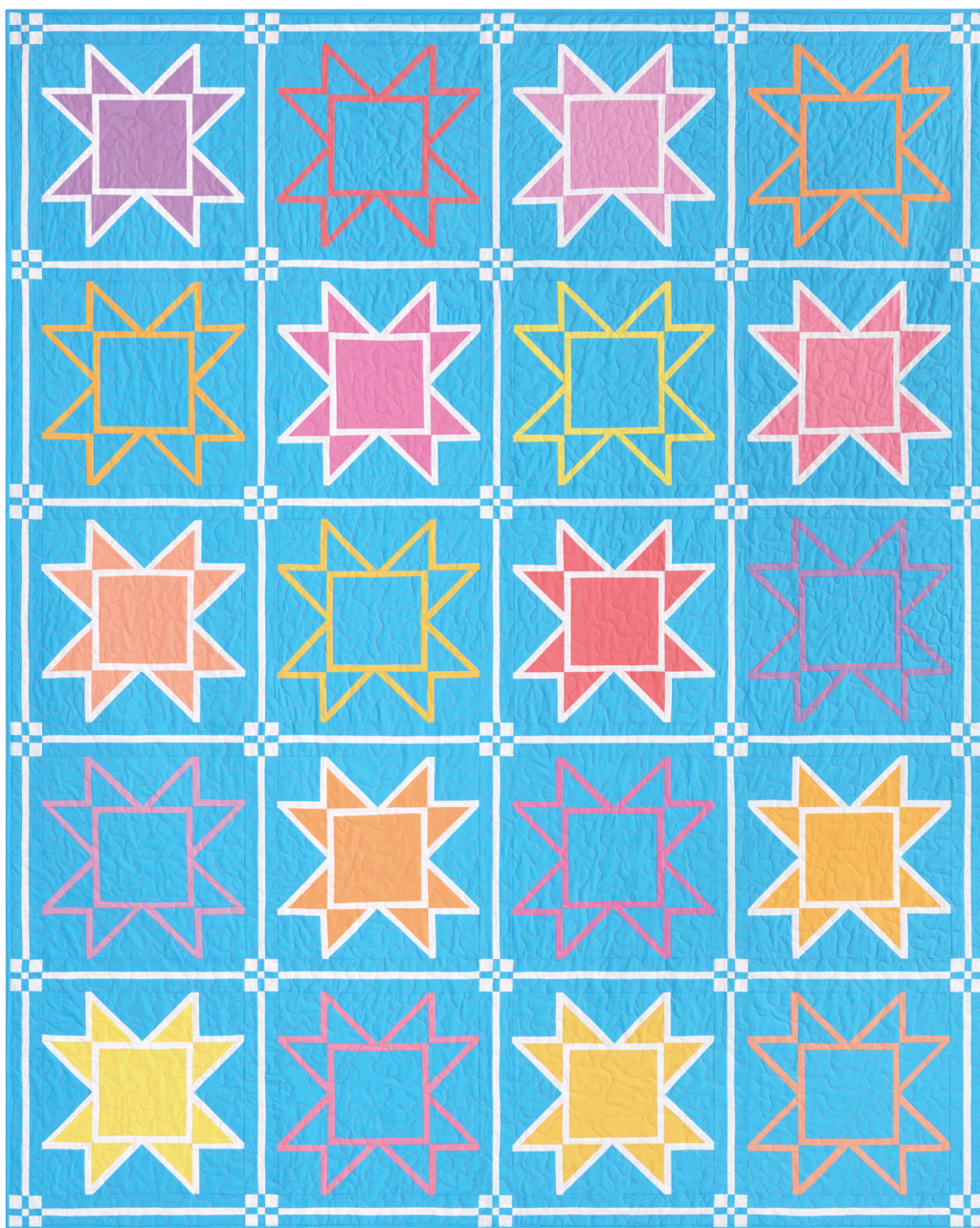

Finished quilt measures: 76-1/2" x 95"

Difficulty Rating: **Intermediate**

ROBERT KAUFMAN
F A B R I C S

For questions about this pattern, please email Patterns@RobertKaufman.com.

Fabric and Supplies Needed

Fabric amounts based on yardage that is 42" wide.

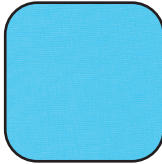
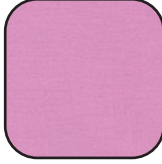
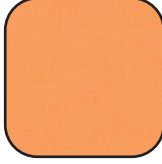
Color	Fabric	Name/SKU	Yardage	Color	Fabric	Name/SKU	Yardage
	A	K001-1914 HORIZON	7-2/3 yards		H	K001-353 SUNFLOWER	1/3 yard
	B	K001-258 PANSY	1/3 yard		I	K001-261 BUBBLE GUM	1/3 yard
	C	K001-185 CREAMSICLE	1/3 yard		J	K001-1228 MELON	1/3 yard
	D	K001-485 BALLERINA	1/3 yard		K	K001-1056 BUTTERCUP	1/3 yard
	E	K001-59 CANTALOE	1/3 yard		L	K001-1387 WHITE	2-5/8 yards
	F	K001-851 MAC AND CHEESE	1/3 yard		Binding*	K001-1914 HORIZON <i>*Also used for Fabric A</i>	2/3 yard
	G	K001-1062 CANDY PINK	1/3 yard	<div>You will also need: 5-3/4 yards for backing</div>			
Copyright 2020, Robert Kaufman For individual use only - Not for resale							

Notes Before You Begin

- Read through all of the instructions before beginning.
- All of the seam allowances are 1/4" unless otherwise noted.
- Press seam allowances open unless otherwise noted.
- Width of fabric (WOF) is equal to at least 42" wide.
- Right sides together has been abbreviated to RST.
- Remember to measure twice and cut once!

Cutting Instructions

From Fabric A, cut:

nine 8-1/2" x WOF strips. Subcut:

eighty 4-1/2" x 8-1/2" rectangles for the flying geese

eight 4" x WOF strips. Subcut:

eighty 4" squares

eight 3-3/4" x WOF strips. Subcut:

eighty 3-3/4" squares. Mark a diagonal on the back of each square.

fifty-two 1-1/2" x WOF strips. Set aside for strip piecing.

two 1" x WOF strips. Set aside for strip piecing.

two 7-1/2" x WOF strips. Subcut:

ten 7-1/2" squares

nine 4-1/2" x WOF strips. Subcut:

eighty 4-1/2" squares

From each of Fabrics B-K, cut:

7-1/2" x 7-1/2"	3-3/4"	3-3/4"	3-3/4"	3-3/4"	4-1/2"	4-1/2"	4-1/2"	4-1/2"
	x	x	x	x	x	x	x	x
	3-3/4"	3-3/4"	3-3/4"	3-3/4"	4-1/2"	4-1/2"	4-1/2"	4-1/2"
	3-3/4"	3-3/4"	3-3/4"	3-3/4"	4-1/2"	4-1/2"	4-1/2"	4-1/2"
	x	x	x	x	x	x	x	x
	3-3/4"	3-3/4"	3-3/4"	3-3/4"	4-1/2"	4-1/2"	4-1/2"	4-1/2"
	1" x 8-1/2"	1" x 7-1/2"	1" x 4-1/2"	1" x 4-1/2"	1" x 4"	1" x 4"		
	1" x 8-1/2"	1" x 7-1/2"	1" x 4-1/2"	1" x 4-1/2"	1" x 4"	1" x 4"		

one 9" x WOF strip. Subcut, following the cutting diagram:

one 7-1/2" square

eight 3-3/4" squares. Mark a diagonal on the back of each square.

eight 4-1/2" squares

two 1" x WOF strips. Subcut:

two 1" x 8-1/2" strips

two 1" x 7-1/2" strips

four 1" x 4-1/2" strips

four 1" x 4" strips

From Fabric L, cut:

nine 4-1/2" x WOF strips. Subcut:

eighty 4-1/2" squares

two 1-1/2" x WOF strips. Set aside for strip piecing.

twenty-six 1" x WOF strips. Set aside for strip piecing.

twenty-two 1" x WOF strips. Subcut:
 twenty 1" x 8-1/2" strips
 twenty 1" x 7-1/2" strips
 forty 1" x 4-1/2" strips
 forty 1" x 4" strips

From the Binding Fabric, cut:
 nine 2-1/2" x WOF strips

Assemble the Flying Geese Units

Step 1: Place a 4-1/2" Fabric L square RST at one end of a Fabric A rectangle. Mark a diagonal line on the wrong side of the square, as shown. Sew on the marked line and trim away the excess fabric, leaving a 1/4" seam allowance. Press toward the triangle.

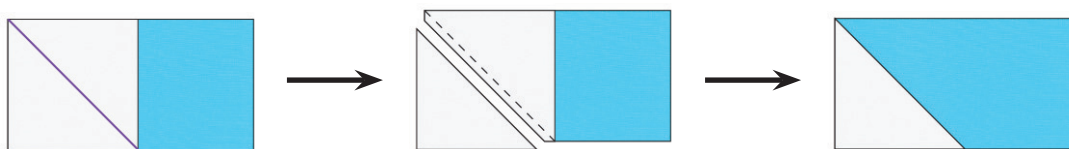

Step 2: Repeat Step 1 at the remaining end of the rectangle. The resulting flying geese block should measure 4-1/2" x 8-1/2".

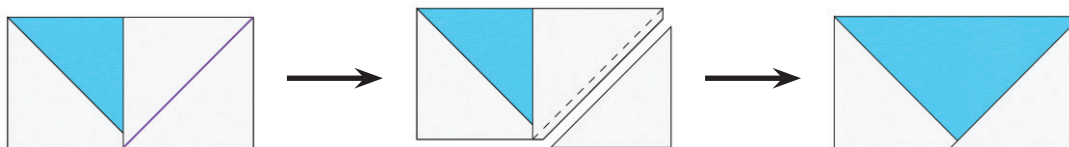

Step 3: Place a 3-3/4" Fabric B square at one end of the Step 2 Flying Geese unit, right sides together. Note the orientation of the marked diagonal line. Sew on the marked line, then trim away the excess fabric, leaving a 1/4" seam allowance. Press. Repeat on the remaining end of the Flying Geese unit with another Fabric B square.

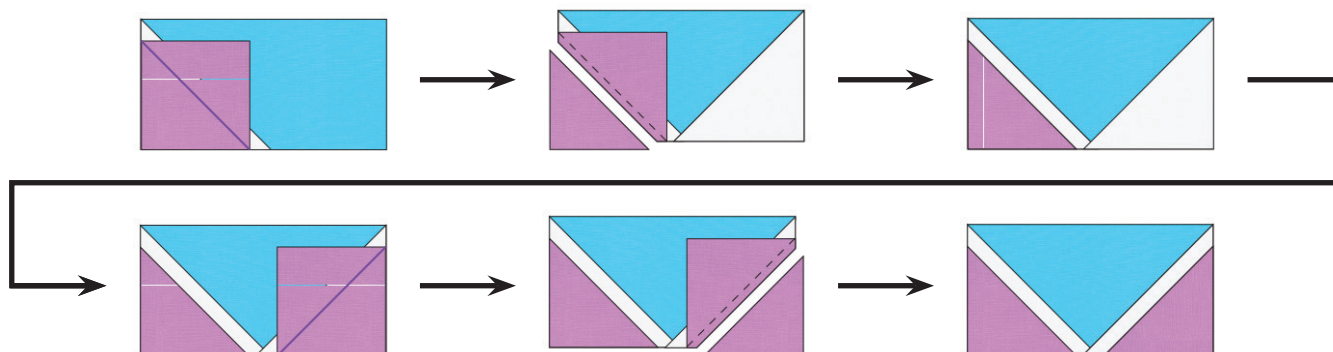

Step 4: Repeat with all remaining Fabric A rectangles to create eighty 4-1/2" x 8-1/2" Flying Geese Units, creating forty with Fabric L "outlines" (and with Fabric B-K "points") and forty with Fabric B-K "outlines" (and Fabric A "points").

Assemble the Block Centers

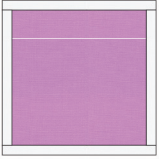

Step 5: Gather:

- one 7-1/2" Fabric B square
- two 1" x 7-1/2" Fabric L strips
- two 1" x 8-1/2" Fabric L strips

Step 6: Sew the 7-1/2" strips to opposite edges of the square. Press. Sew the 8-1/2" strips to the remaining edges of the square. Press.

Repeat to make twenty Block Centers: ten with Fabric A squares and one of each of Fabrics B-K "outlines" and ten Block Centers with Fabric B-K squares and Fabric L "outlines."

Assemble the Block Corners



Step 7: Gather:

- one 4-1/2" Fabric A square
- one 1" x 4" Fabric L strip
- one 1" x 4-1/2" Fabric L strip

Step 8: Sew the 4" strip to the right edge of the square. Press. Sew the 4-1/2" strips to the bottom edge of the square. Press.

Step 9: Repeat to make eighty Block Corners: forty with Fabric A squares and Fabrics L "outlines" and forty Block Corners with Fabric A squares and Fabric B-K "outlines" (four of each, B-K).

Assemble the Blocks

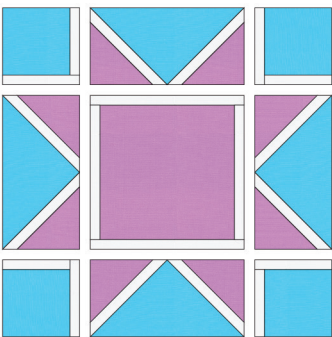

Step 10: Gather:

- one Fabric B Block Center
- four Block Corners, from Fabrics A/L
- four Fabric B Flying Geese Units

Arrange the units into three rows of three. Note the fabric placement and block orientation in the Block Assembly Diagram.

Step 11: Sew the units together to form the rows. Press the seams away from the flying geese units.

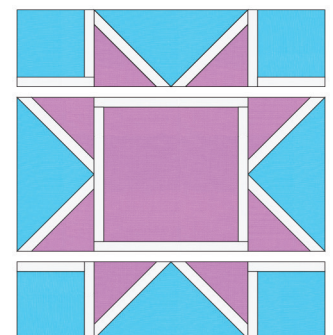

Step 12: Sew the rows together, nesting the seams and pressing the seams to one side to form the block.

The Block should measure 16-1/2" square. Repeat to make a total of twenty Blocks, using the Quilt Assembly Diagram as a guide for fabric placement.

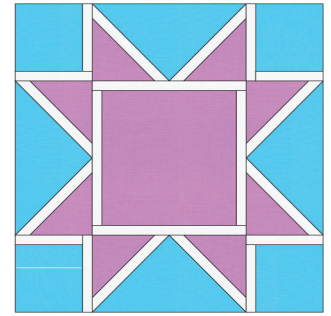

Assemble the Strip Set Units

Step 13: Sew a 1-1/2" Fabric A strip to both long edges of a 1" Fabric L strip. Press the seam toward the darker fabric.

Repeat to make twenty-five strip sets like this. Subcut to make a total of forty-nine 16-1/2" long block sashing units.



Step 14: Sew a 1-1/2" Fabric L strip to both long edges of a 1" Fabric A strip. Press the seam toward the darker fabric. Repeat to make two strip sets like this. Subcut to make a total of sixty 1-1/2" x 3" units.



Step 15: Sew a 1-1/2" Fabric A strip to both long edges of a 1" Fabric L strip. Press the seam toward the darker fabric. Subcut to make a total of thirty 1" x 3" units.

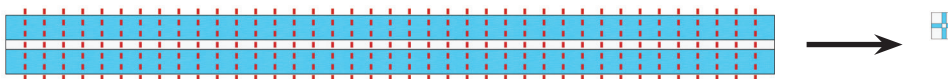

Step 16: Sew two Step 14 units and one Step 15 unit together, as shown, to form a 3" Cornerstone. Repeat to make a total of thirty Cornerstones.

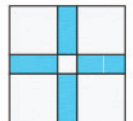

Assemble the Quilt

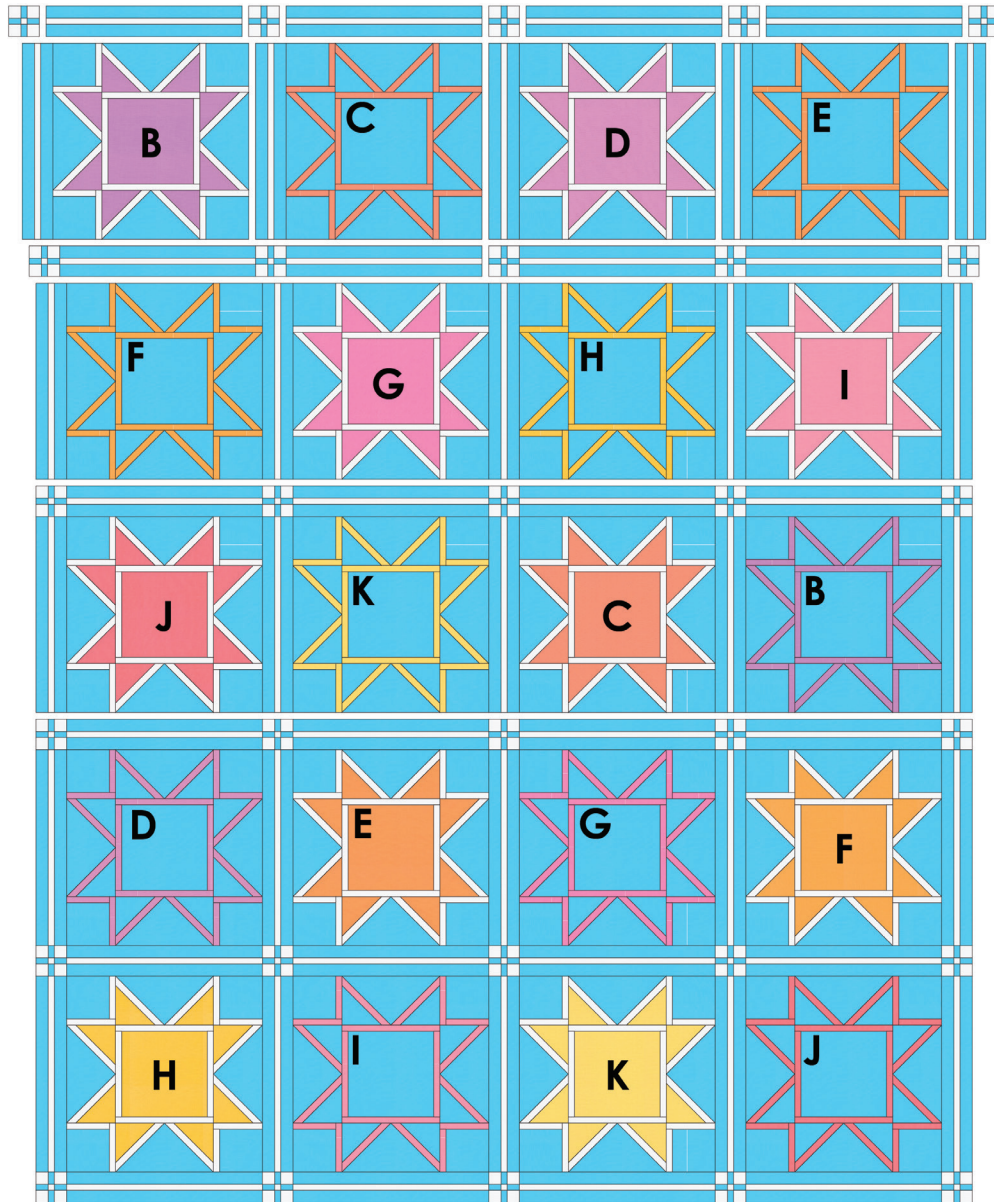

Step 17: Arrange the Blocks together as indicated in the Quilt Assembly Diagram. Sew each row together, using sashing strips between each block and at the beginning and end of each row. Press seams toward the sashing. Repeat to make five block rows.

Step 18: Gather five cornerstone squares and four sashing strips. Sew each row together, using cornerstones between each sashing strip and at the beginning and end of each row. Press seams toward the sashing. Repeat to make six sashing rows.

Step 19: Sew the sashing and block rows together, pinning and nesting the seams. Press seams open or to the sashing.

Your quilt top is complete! Baste, quilt, bind and enjoy!

This pattern may be used for personal purposes only and may not be reproduced in any form without the express permission from Robert Kaufman Fabrics. This pattern is not for resale. All patterns, unless otherwise attributed, are © Robert Kaufman Co., Inc. 2005-2020. All rights reserved.