

# JACK-O-LANTERN TOPPER

Designed by Elise Lea for RK  
[www.robertkaufman.com](http://www.robertkaufman.com)

Featuring



LIGHTS OUT! 

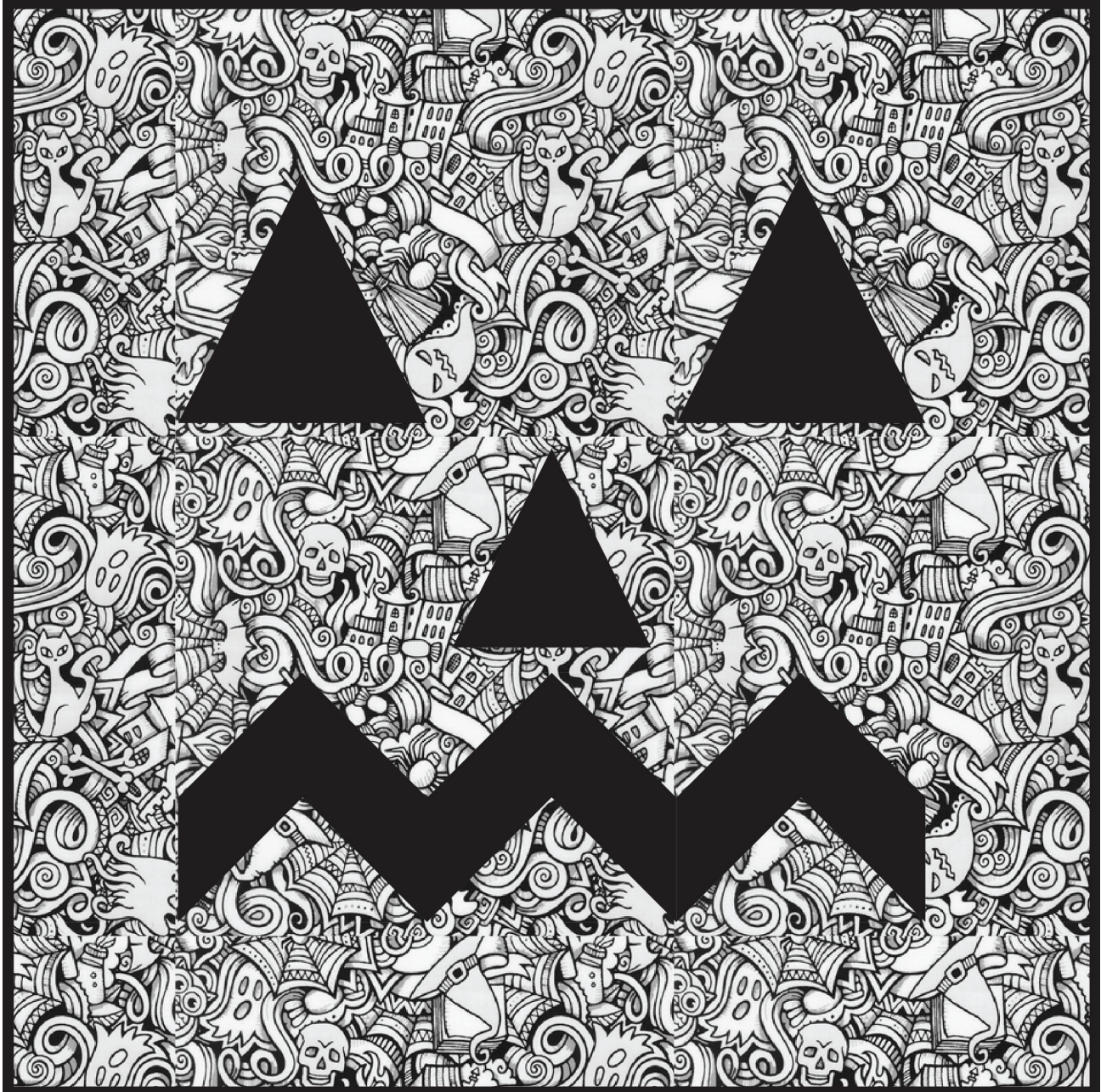

Finished size: 22" x 22"



Difficulty Rating: **Intermediate**

**ROBERTKAUFMAN**  
F A B R I C S

For questions about this pattern, please email [Patterns@RobertKaufman.com](mailto:Patterns@RobertKaufman.com).

## Fabric and Supplies Needed

*Fabric amounts based on yardage that is 42" wide.*

Color	Fabric	Name/SKU	Yardage	Color	Fabric	Name/SKU	Yardage
	A	K001-1019 BLACK	1/3 yard		Binding*	K001-1019 BLACK <small>*Also used for Fabric A</small>	1/4 yard
	B	SRK-21727-182 LICORICE	5/8 yard	<p>You will also need: 7/8 yard for backing</p>			
<p>Copyright 2023, Robert Kaufman For individual use only - Not for resale</p>							

## Notes Before You Begin

- Read through all of the instructions before beginning.
- All of the seam allowances are 1/4" unless otherwise noted.
- Press seam allowances open unless otherwise noted.
- Width of fabric (WOF) is equal to at least 42" wide.
- Right sides together has been abbreviated to RST.
- Remember to measure twice and cut once!



## Cutting Instructions

### From Fabric A, cut:

one 6" x WOF strip. Subcut:

two 6" squares

one 5" square

one 3" x WOF strip. Subcut:

three 3" x 5-1/2" rectangles

six 3" squares

### From Fabric B, cut:

one 5-1/2" x WOF strip. Subcut:

two 5-1/2" x 6" rectangles

one 5-1/2" square

two 4" x WOF strips. Subcut:

two 4" x 22-1/2" rectangles

two 4" x 15-1/2" rectangles

From the remainder, cut:

two 1" x 4-1/2" rectangles

one 3-1/2" x WOF strip. Subcut:

four 3-1/2" x 6-3/4" rectangles

one 3" x WOF strip. Subcut:

three 3" x 5-1/2" rectangles

six 3" squares

### From the Binding Fabric, cut:

three 2-1/2" x WOF strips.

## Assemble the Paper Pieced Units

**Step 1:** Using one 6" Fabric A square and two 3-1/2" x 6-3/4" Fabric B rectangles, paper piece one Template 1 unit. Trim to the outer edge of the template, leaving a 5-1/2" unit. Repeat to make two Eye Units.

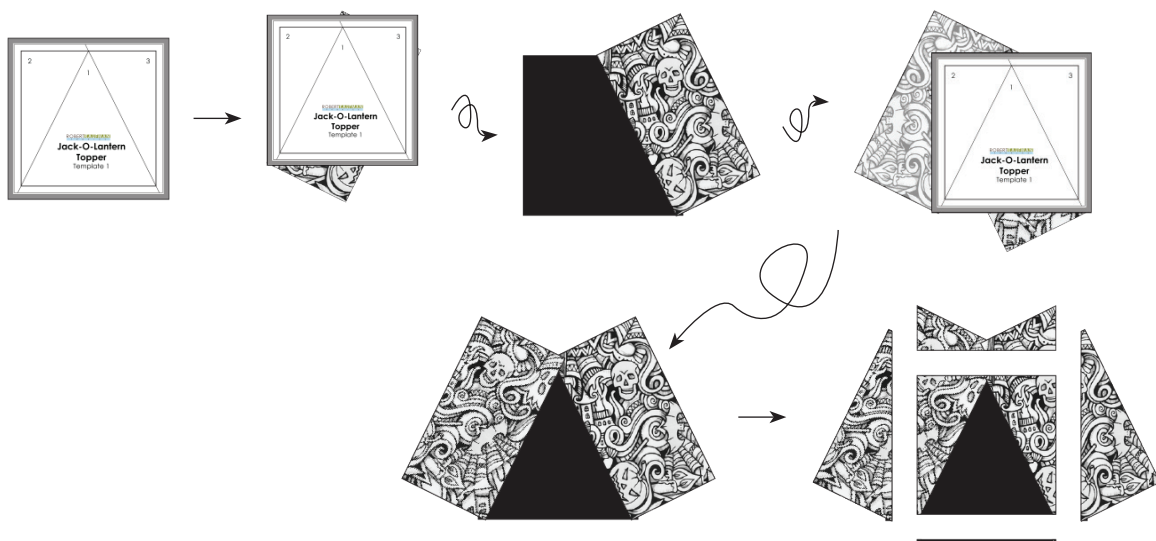

**Step 2:** Using one 5" Fabric A square and two 3-1/2" x 6-3/4" Fabric B rectangles, paper piece one Template 2 unit. Trim to the outer edge of the template.

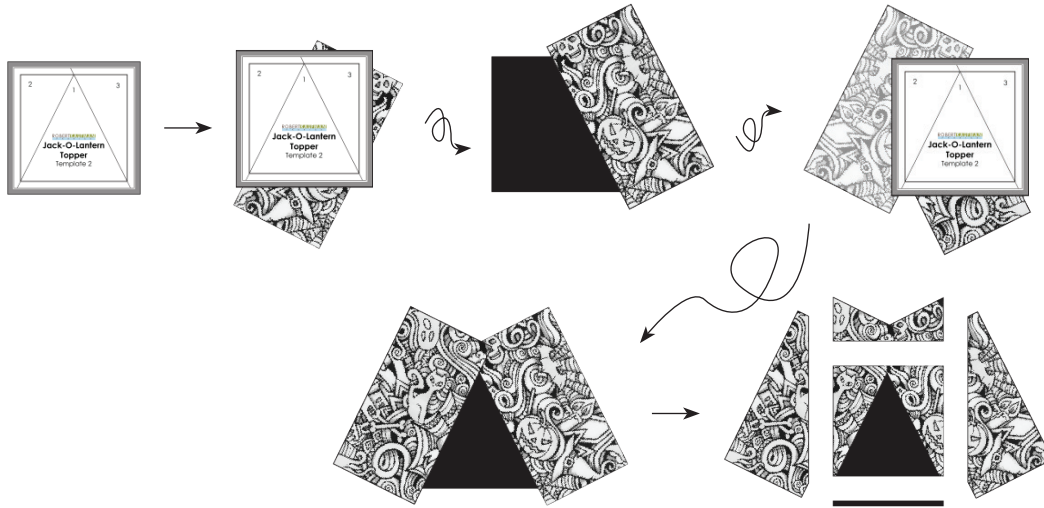

Sew the 1" x 4-1/2" Fabric B rectangles to the top and bottom of the unit. The resulting Nose Unit will measure 4-1/2" x 5-1/2".



### Assemble the Flying Geese

**Step 3:** Place a 3" Fabric B square RST at one end of a 3" x 5-1/2" Fabric A rectangle. Mark a diagonal line on the wrong side of the square, as shown. Sew on the marked line and trim away the excess fabric, leaving a 1/4" seam allowance. Press toward the triangle.



**Step 4:** Repeat Step 1 at the remaining end of the rectangle. The resulting flying geese block should measure 3" x 5-1/2". Repeat to make three A/B Flying Geese.

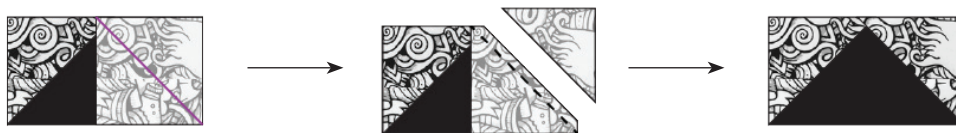

**Step 5:** Repeat to make a total of three B/A flying geese



**Step 6:** Sew the flying geese units together in two rows of three, as shown. Sew the units together to form rows, pressing the seams in opposite directions, before sewing the rows together, nesting the seams and pressing to one side. The finished Mouth should measure 5-1/2" x 15-1/2".



## Assemble the Block

**Step 7:** Gather:  
both A/C Eye Units  
the A/C Nose Unit  
two 5-1/2" x 6" Fabric C rectangles  
one 5-1/2" Fabric C square  
the A/C Mouth Unit

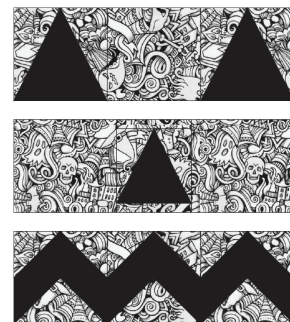

Arrange the units into three rows. Note the fabric placement and block orientation in the Block Assembly Diagram.

**Step 8:** Sew the first and second group of units together to form the top two rows, with the 5-1/2" square being sewn between the Eye Units and the 5-1/2" x 6" rectangles being sewn to opposite edges of the Nose Unit. Press the seams in opposite directions in each row.

**Step 9:** Sew the three rows together, nesting the seams and pressing the seams to one side to form the block center. The Mouth section can be sewn as shown for a frown, or rotated 180 degrees to make a smile.

**Step 10:** Sew the 4" x 15-1/2" Fabric B rectangles to the left and right edges of the block center. Press. Sew the 4" x 22-1/2" Fabric B rectangles to the top and bottom edges of the block center. Press.

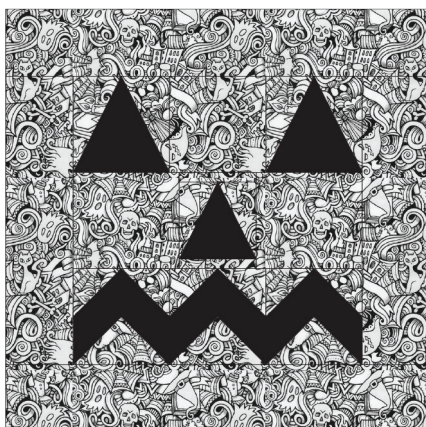

The resulting Block should measure 22-1/2" square. Your project top is complete! Baste, quilt, bind, and enjoy!

## Templates

Copy all templates at 100% and confirm size using the 1" test square.  
Print or copy one of Template 1 and one of Template 2 .

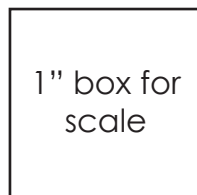
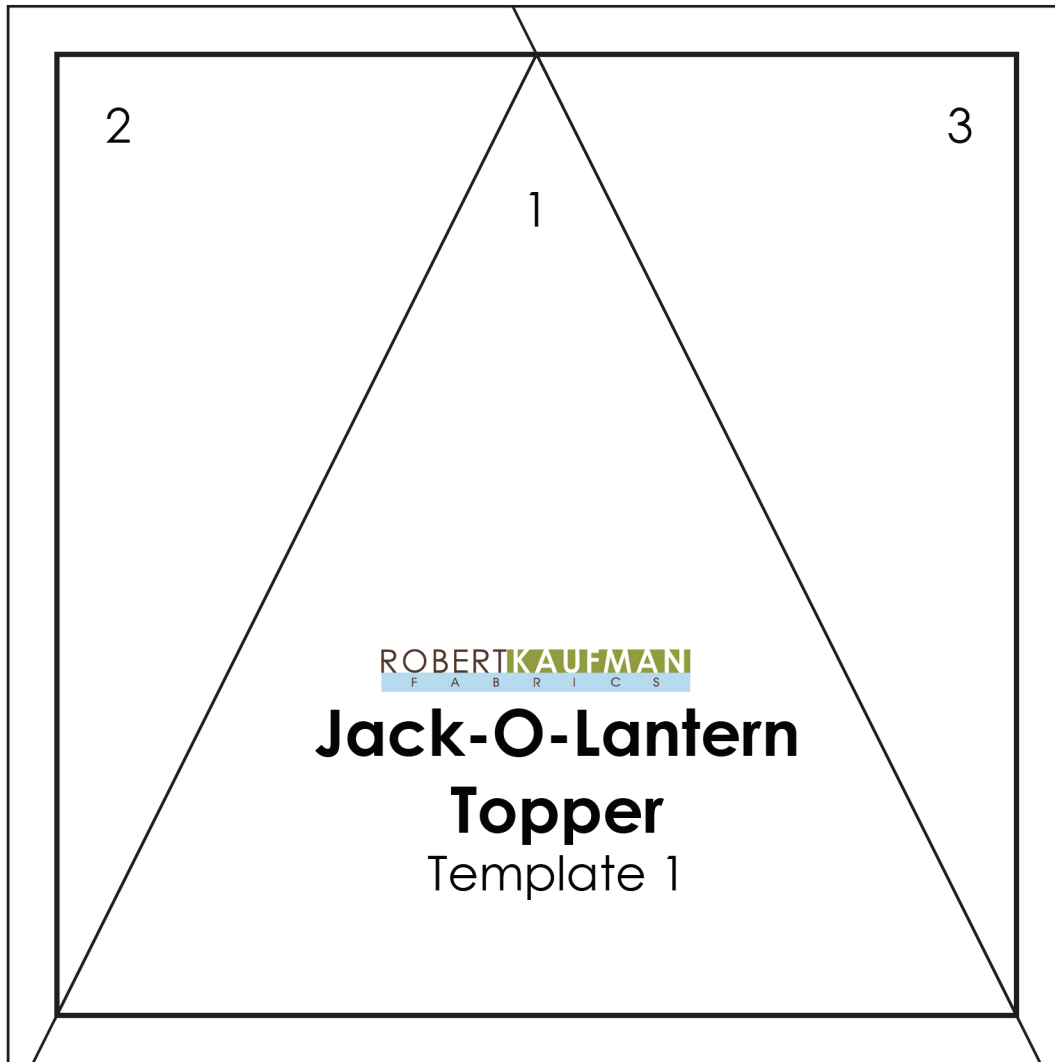

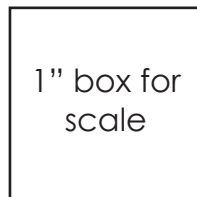
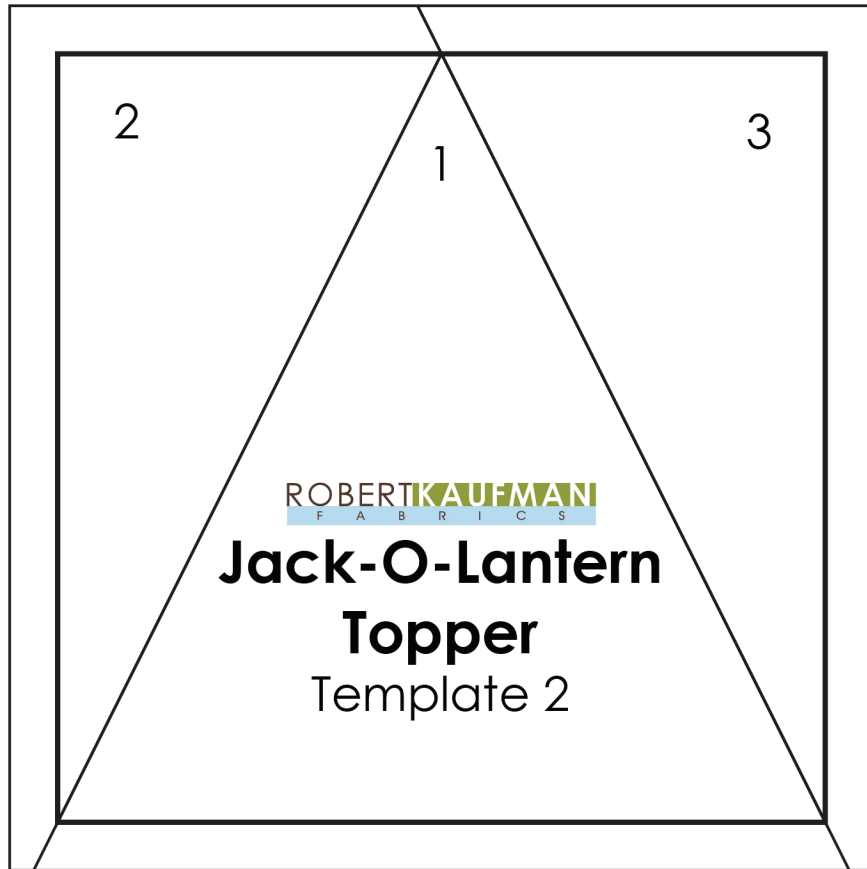

This pattern may be used for personal purposes only and may not be reproduced in any form without the express permission from Robert Kaufman Fabrics. This pattern is not for resale. All patterns, unless otherwise attributed, are © Robert Kaufman Co., Inc. 2005-2023. All rights reserved.