

FLORESENCE

Designed by Ariga Mahmoudlou for RK Featuring
www.robertkaufman.com

Natural Blooms
Wishwell
fabrics for daydreamers

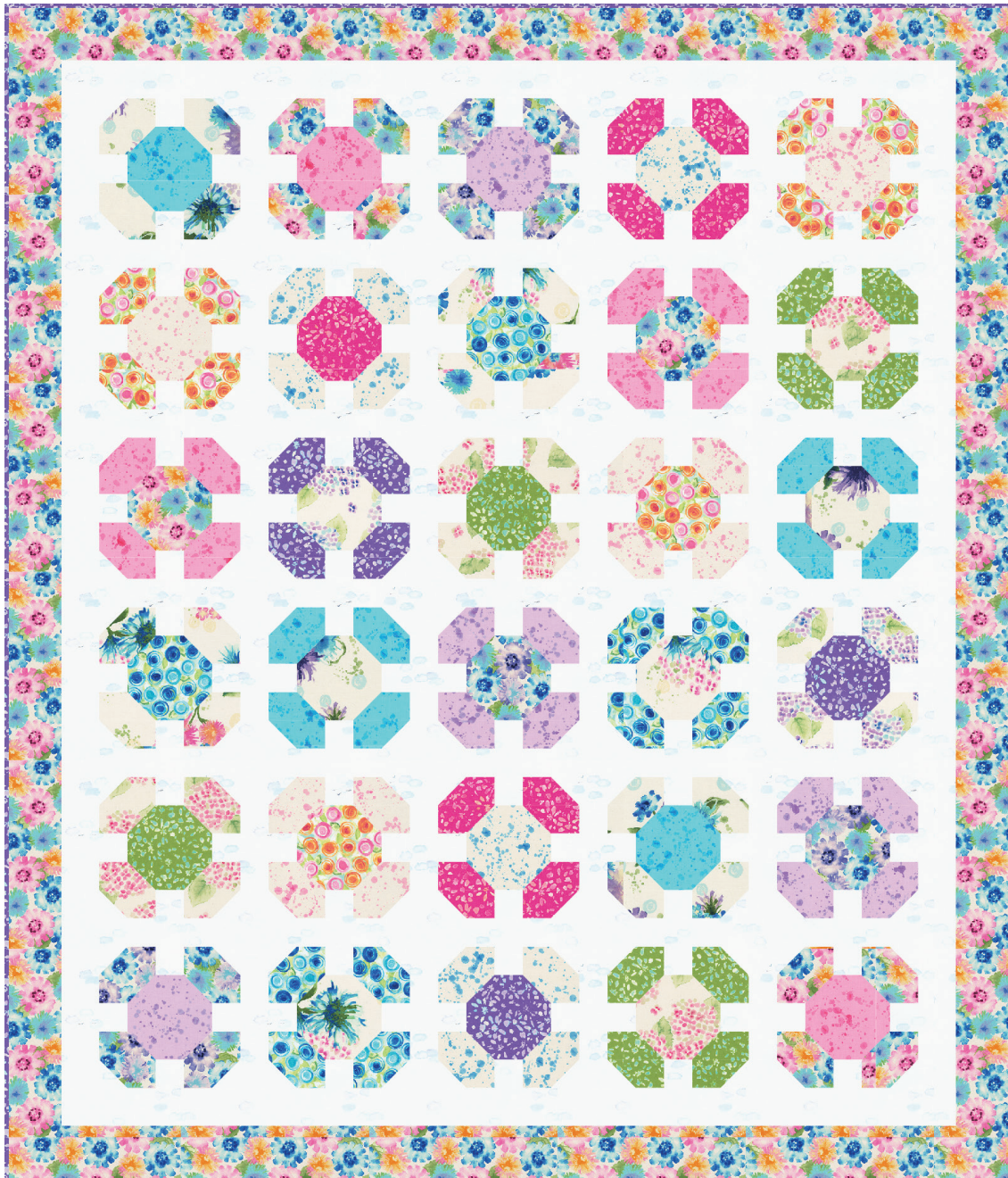

Finished quilt measures: 53-1/2" x 62-1/2"













Difficulty Rating: **Intermediate**

ROBERT KAUFMAN
F A B R I C S

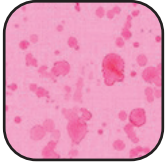
For questions about this pattern, please email Patterns@RobertKaufman.com.

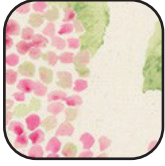
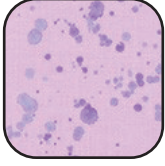
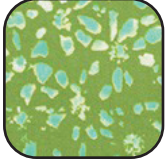

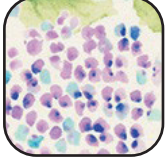
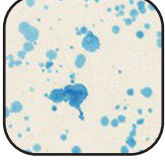
Fabric and Supplies Needed

Fabric amounts based on yardage that is 42" wide.

Color	Fabric	Name/SKU	Yardage	Color	Fabric	Name/SKU	Yardage
		FQ-1653-16 BRIGHT <i>contains Fabrics A-P</i>	One Fat Quarter bundle		I	WEL-19543-97 ROSE	one fat quarter included in Fat Quarter Bundle
	A	WEL-19543-370 POOL	one fat quarter included in Fat Quarter Bundle		J	WEL-19540-104 PRIMROSE	one fat quarter included in Fat Quarter Bundle
	B	WEL-19538-234 WISTERIA	one fat quarter included in Fat Quarter Bundle		K	WEL-19540-71 LAGOON	one fat quarter included in Fat Quarter Bundle
	C	WEL-19543-106 BLOSSOM	one fat quarter included in Fat Quarter Bundle		L	WEL-19538-107 PETAL	one fat quarter included in Fat Quarter Bundle
	D	WEL-19541-107 PETAL	one fat quarter included in Fat Quarter Bundle		M	WEL-19539-301 AZALEA	one fat quarter included in Fat Quarter Bundle
	E	WEL-19543-21 LILAC	one fat quarter included in Fat Quarter Bundle		N	WEL-19542-43 LEAF	one fat quarter included in Fat Quarter Bundle
	F	WEL-19541-234 WISTERIA	one fat quarter included in Fat Quarter Bundle		O	WEL-19539-23 LAVENDER	one fat quarter included in Fat Quarter Bundle
	G	WEL-19543-333 SEA GLASS	one fat quarter included in Fat Quarter Bundle		P	WEL-19542-22 VIOLET	one fat quarter included in Fat Quarter Bundle
	H	WEL-19542-301 AZALEA	one fat quarter included in Fat Quarter Bundle				

Fabric and Supplies Needed

Fabric amounts based on yardage that is 42" wide.

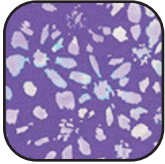
Color	Fabric	Name/SKU	Yardage	Color	Fabric	Name/SKU	Yardage
Plus additional yardage of Fabrics Q&R							
	Q	WELD-19620-216 CLOUD	1-2/3 yard		R	WEL-19541-107 PETAL <i>Also used for Fabric D</i>	2/3 yard
Copyright 2020, Robert Kaufman For individual use only - Not for resale					Binding*	WEL-19542-22 VIOLET <i>*Also used for Fabric P</i>	1/2 yard
				You will also need: 3-1/2 yards for backing			

Notes Before You Begin

- Read through all of the instructions before beginning.
- All of the seam allowances are 1/4" unless otherwise noted.
- Press seam allowances open unless otherwise noted.
- Width of fabric (WOF) is equal to at least 42" wide.
- Right sides together has been abbreviated to RST.
- Remember to measure twice and cut once!

Cutting Instructions

From each of Fabrics A-P, cut:

two 5" squares
 thirty-two 2" squares.

Additionally, from **Fabrics B, D, F and J**, cut one 2-1/2" square for the HSTs

Note: You will not use sixteen of the 2" squares from each of Fabrics P and G, or one of the 5" squares from each of Fabrics H and O.

From Fabric R, cut:

six 3-1/2" x WOF strips. Sew together, end-to-end, then trim:
 two 3-1/2" x 57" side outer borders
 two 3-1/2" x 54" top/bottom outer borders

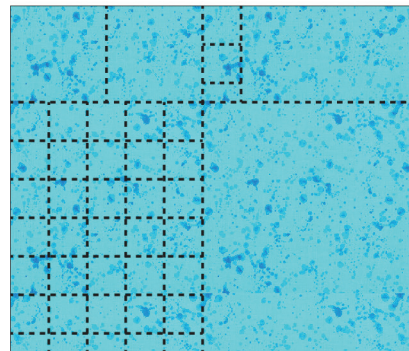

From Fabric Q, cut:

three 5" x WOF strips. Subcut:

twenty 5" squares

Trim the remainder of the last strip to 2-1/2" wide, then subcut:

four 2-1/2" squares for the HSTs

five 2-1/2" x WOF strips. Sew together, end-to-end, then trim:

two 2-1/2" x 53" side inner borders

two 2-1/2" x 48" top/bottom inner borders

fifteen 2" x WOF strips. Subcut:

sixty-seven 2" x 5" rectangles

one hundred twenty 2" squares

From the Binding Fabric, cut:

six 2-1/2" x WOF strips

Assemble the Half-Square Triangles (HSTs)

Step 1: Pair a 2-1/2" Fabric Q square with a 2-1/2" Fabric B square, RST. Mark a diagonal line on the wrong side of one square. Sew 1/4" away from both sides of the marked line. Cut on the marked line, creating two half-square triangles (HSTs). Press toward the darker fabric. Trim to 2" square. Repeat to make:



one Q/J HST



one Q/D HST

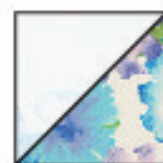

one Q/F HST

Assemble the Stitch and Flip Units

Note: The steps in this section involve stitching in marked diagonal lines. You may mark a diagonal line on your 2" squares used here, if you wish, or simply eyeball the stitching lines.

Step 2: Place a 2" Fabric B square at the left end a Fabric Q rectangle, right sides together. Note the orientation of the marked diagonal line shown here. Sew on the marked line, then trim away the excess fabric, leaving a 1/4" seam allowance. Press. Repeat on the right end with a 2" Fabric D square.

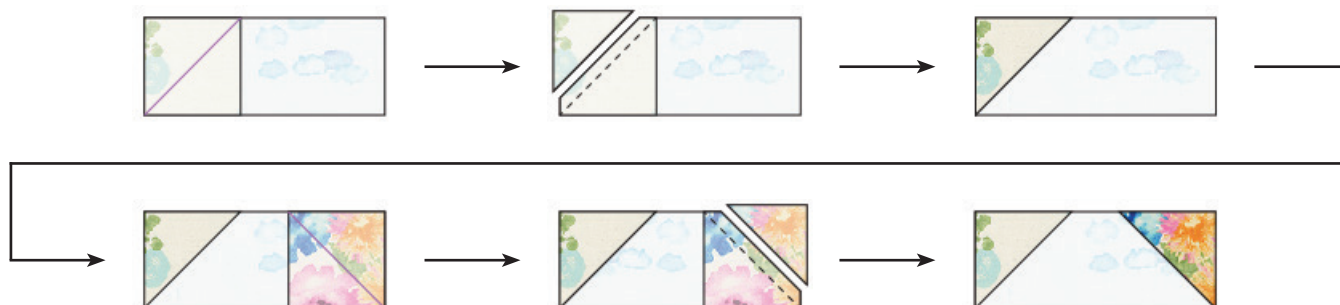

Step 3: Referring to the fabric placement and pairings in the Quilt Assembly Diagram, repeat Step 2 to make a total of eighteen units. These will be used around the outermost pieced edge of the quilt center.

Step 4: Place a 2" Fabric B square in the upper right corner of a 5" Fabric A square, right sides together. Note the orientation of the marked diagonal line. Sew on the marked line, then trim away the excess fabric, leaving a 1/4" seam allowance. Press. Repeat on the remaining corners of the 5" square.

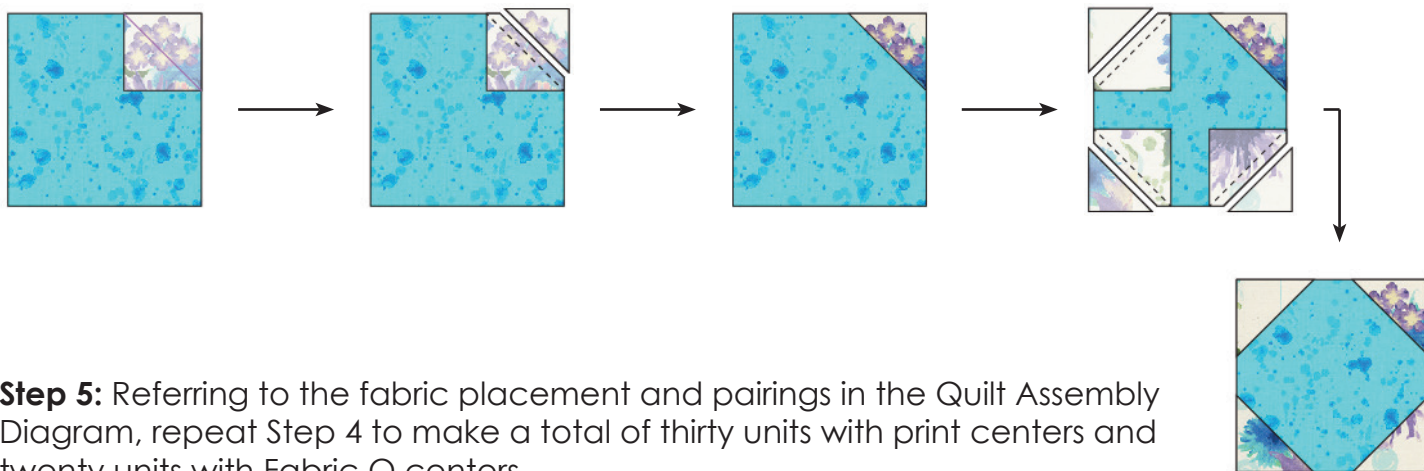

Step 5: Referring to the fabric placement and pairings in the Quilt Assembly Diagram, repeat Step 4 to make a total of thirty units with print centers and twenty units with Fabric Q centers.

Assemble the Pieced Units

Step 6: Sew a 2" Fabric B square to opposite edges of a 2" Fabric Q square. Press away from Fabric Q.



Step 7: Referring to the fabric placement and pairings in the Quilt Assembly Diagram, repeat Step 6 to make a total of twenty-two units, each for the outside edge of the quilt.

Step 8: Referring to the fabric placement and pairings in the Quilt Assembly Diagram, repeat Step 6 to make a total of ninety-eight units, each for the inner portion of the quilt center. Note that some of these units will be made from the same fabrics on either side of the Q square, but that some units will be made with different fabrics on either side of the Q square. It is best to organize your finished pieces by row, in piles, for easier sewing later.

Step 9: Referring to the Quilt Assembly Diagram for fabric pairings and placement, gather two units from Step 8 and one 2" x 5" Fabric Q rectangle. Sew together as shown and press away from the Q rectangle.



Step 10: Referring to the fabric placement and pairings in the Quilt Assembly Diagram, repeat Step 9 to make a total of forty-nine units.

Assemble the Quilt

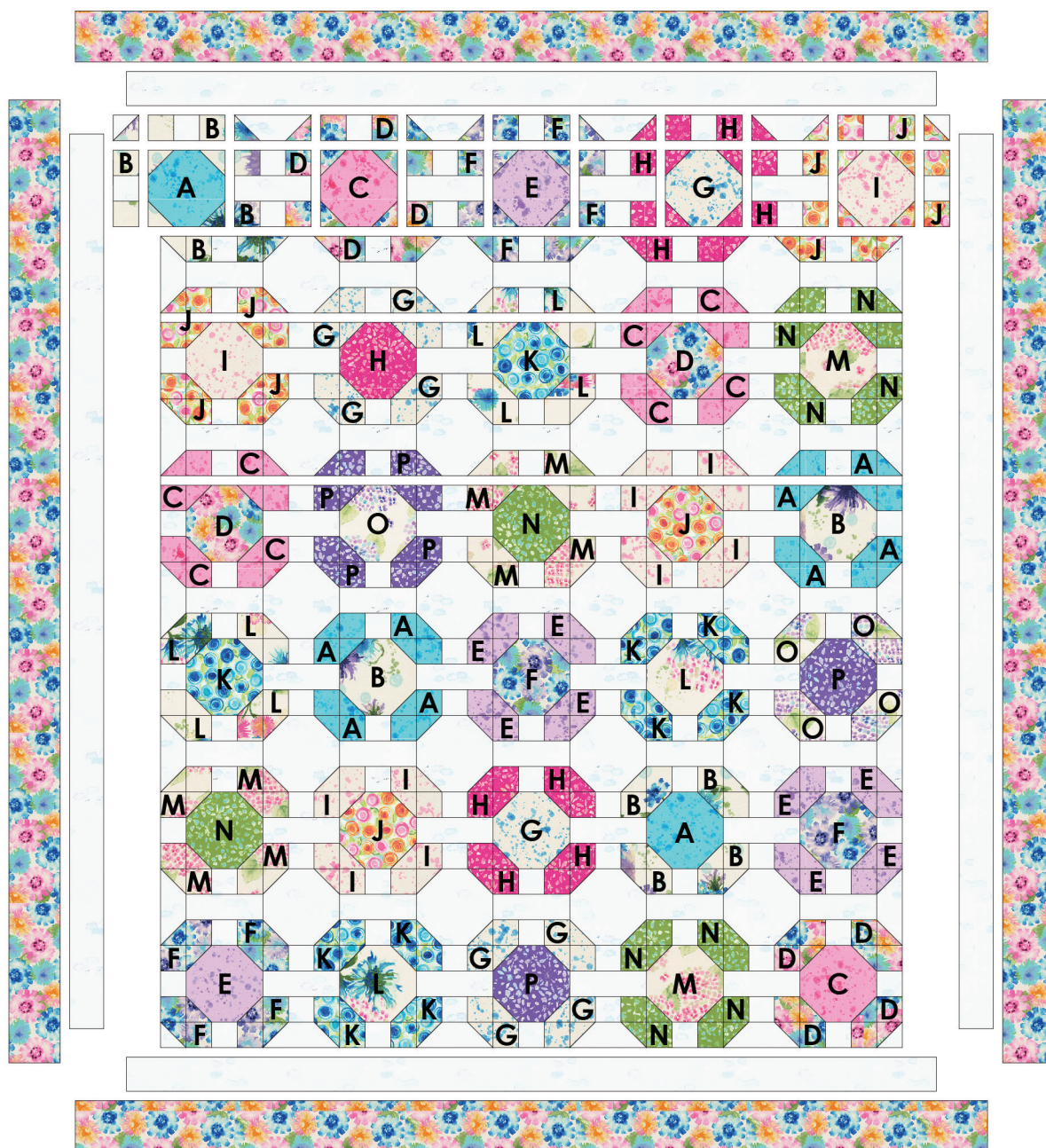

Step 11:

Arrange the HSTs, stitch-and-flip, and pieced units into rows as shown. Note the fabric placement and block orientation in the Quilt Assembly Diagram.

Step 12:

Sew the units together to form rows. Press the seams away from the stitch and flip units.

Step 13:

Sew the rows together to form the quilt center. Press the row seams open.

Step 14: Sew the side inner borders to the sides of the quilt center. Press toward the borders. Sew the top and bottom inner borders to the quilt center. Press toward the borders.

Step 15: Sew the side outer borders to the sides of the quilt center. Press toward the borders. Sew the top and bottom outer borders to the quilt center. Press toward the borders.

Your quilt top is complete! Baste, quilt, bind and enjoy!

This pattern may be used for personal purposes only and may not be reproduced in any form without the express permission from Robert Kaufman Fabrics. This pattern is not for resale. All patterns, unless otherwise attributed, are © Robert Kaufman Co., Inc. 2005-2020. All rights reserved.