

# FLORESENCE

Designed by Ariga Wilson for RK  
[www.robertkaufman.com](http://www.robertkaufman.com)

Featuring *Wishwell*

**Garden Gloss**  
sateen

Vanessa Lillrose & Linda Fitch

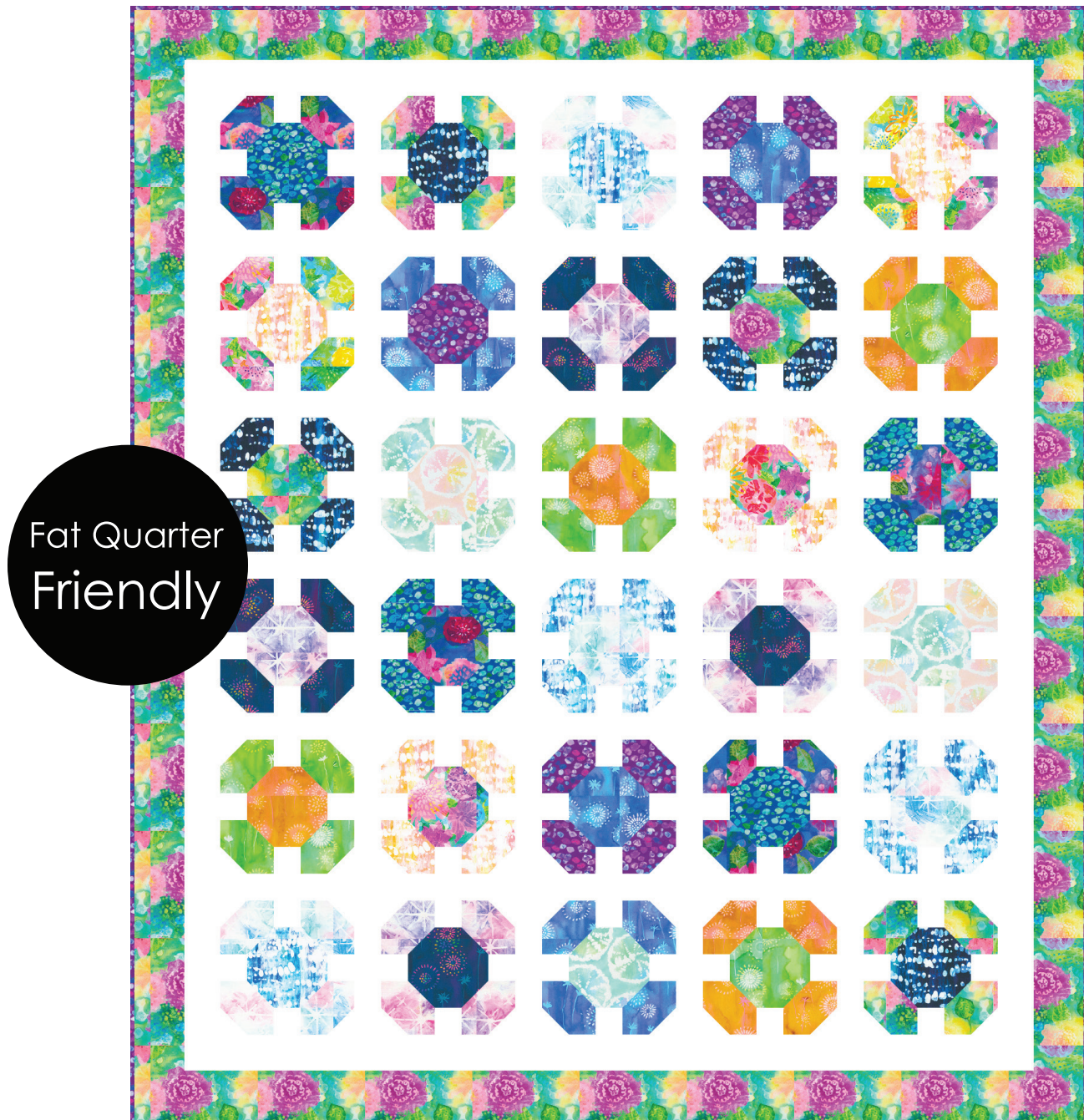

Finished quilt measures: 53-1/2" x 62-1/2"

Difficulty Rating: **Intermediate**

**ROBERT KAUFMAN**  
F A B R I C S

For questions about this pattern, please email [Patterns@RobertKaufman.com](mailto:Patterns@RobertKaufman.com).

# Fabric and Supplies Needed



Fabric amounts based on yardage that is 42" wide.

Color	Fabric	Name/SKU	Yardage	Color	Fabric	Name/SKU	Yardage
		FQ-1857-18 GARDEN GLOSS <i>contains Fabrics A-P</i>	One Fat Quarter bundle		I	WELDS-20884-130 SUNSHINE	one fat quarter included in Fat Quarter Bundle
	A	WELDS-20885-73 LAKE	one fat quarter included in Fat Quarter Bundle		J	WELDS-20886-263 RAINBOW	one fat quarter included in Fat Quarter Bundle
	B	WELDS-20879-228 LAPIS	one fat quarter included in Fat Quarter Bundle		K	WELDS-20883-234 WISTERIA	one fat quarter included in Fat Quarter Bundle
	C	WELDS-20884-60 PACIFIC	one fat quarter included in Fat Quarter Bundle		L	WELDS-20880-438 NIGHT	one fat quarter included in Fat Quarter Bundle
	D	WELDS-20879-270 MEADOW	one fat quarter included in Fat Quarter Bundle		M	WELDS-20880-47 GRASS	one fat quarter included in Fat Quarter Bundle
	E	WELDS-20884-405 WATERFALL	one fat quarter included in Fat Quarter Bundle		N	WELDS-20880-125 SUNFLOWER	one fat quarter included in Fat Quarter Bundle
	F	WELDS-20883-390 BREEZE	one fat quarter included in Fat Quarter Bundle		O	WELDS-20881-376 SHELL	one fat quarter included in Fat Quarter Bundle
	G	WELDS-20880-61 PERIWINKLE	one fat quarter included in Fat Quarter Bundle		P	WELDS-20881-333 SEA GLASS	one fat quarter included in Fat Quarter Bundle
	H	WELDS-20885-251 HELIOTROPE	one fat quarter included in Fat Quarter Bundle	Note: WELDS-20882-59 OCEAN and WELDS-20882-143 CORAL Will not be used in the quilt.			

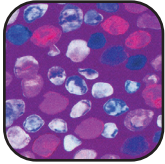

## Fabric and Supplies Needed

*Fabric amounts based on yardage that is 42" wide.*

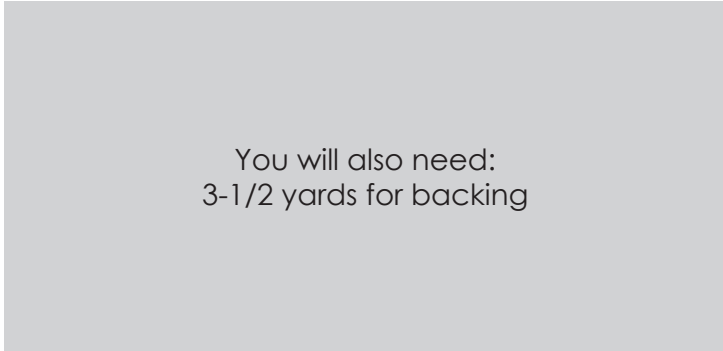
Color	Fabric	Name/SKU	Yardage	Color	Fabric	Name/SKU	Yardage
Plus additional yardage of Fabrics Q&R							
	Q	K001-1387 WHITE	1-2/3 yard		Binding*	WELDS-20885-251 HELIOTROPE	1/2 yard
	R	WELDS-20879-270 MEADOW <i>Also used for Fabric D</i>	2/3 yard	<i>*Also used for Fabric H</i>			
Copyright 2021, Robert Kaufman For individual use only - Not for resale				 <p>You will also need: 3-1/2 yards for backing</p>			

## Notes Before You Begin

- Read through all of the instructions before beginning.
- All of the seam allowances are 1/4" unless otherwise noted.
- Press seam allowances open unless otherwise noted.
- Width of fabric (WOF) is equal to at least 42" wide.
- Right sides together has been abbreviated to RST.
- Remember to measure twice and cut once!

## Cutting Instructions

### From each of Fabrics A-P, cut:

two 5" squares  
thirty-two 2" squares.

Additionally, from **Fabrics B, D, F and J**, cut one 2-1/2" square for the HSTs

*Note: You will not use sixteen of the 2" squares from each of Fabrics P and G, or one of the 5" squares from each of Fabrics H and O.*

### From Fabric R, cut:

six 3-1/2" x WOF strips. Sew together, end-to-end, then trim:  
two 3-1/2" x 57" side outer borders  
two 3-1/2" x 54" top/bottom outer borders

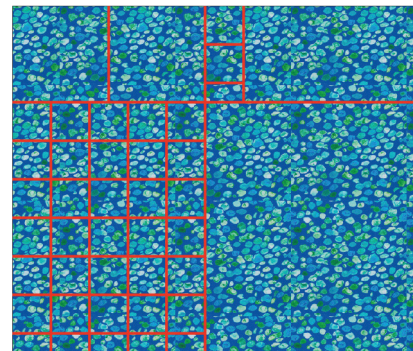

**From Fabric Q, cut:**

three 5" x WOF strips. Subcut:

twenty 5" squares

Trim the remainder of the last strip to 2-1/2" wide, then subcut:

four 2-1/2" squares for the HSTs

five 2-1/2" x WOF strips. Sew together, end-to-end, then trim:

two 2-1/2" x 53" side inner borders

two 2-1/2" x 48" top/bottom inner borders

fifteen 2" x WOF strips. Subcut:

sixty-seven 2" x 5" rectangles

one hundred twenty 2" squares

**From the Binding Fabric, cut:**

six 2-1/2" x WOF strips

## Assemble the Half-Square Triangles (HSTs)

**Step 1:** Pair a 2-1/2" Fabric Q square with a 2-1/2" Fabric B square, RST. Mark a diagonal line on the wrong side of one square. Sew 1/4" away from both sides of the marked line. Cut on the marked line, creating two half-square triangles (HSTs). Press toward the darker fabric. Trim to 2" square. Repeat to make:

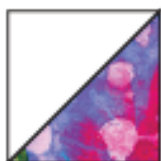

one Q/B HST

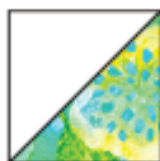

one Q/J HST

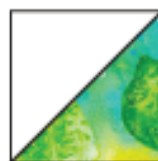

one Q/D HST



one Q/F HST

## Assemble the Stitch and Flip Units

*Note: The steps in this section involve stitching in marked diagonal lines. You may mark a diagonal line on your 2" squares used here, if you wish, or simply eyeball the stitching lines.*

**Step 2:** Place a 2" Fabric B square at the left end a Fabric Q rectangle, right sides together. Note the orientation of the marked diagonal line shown here. Sew on the marked line, then trim away the excess fabric, leaving a 1/4" seam allowance. Press. Repeat on the right end with a 2" Fabric D square.

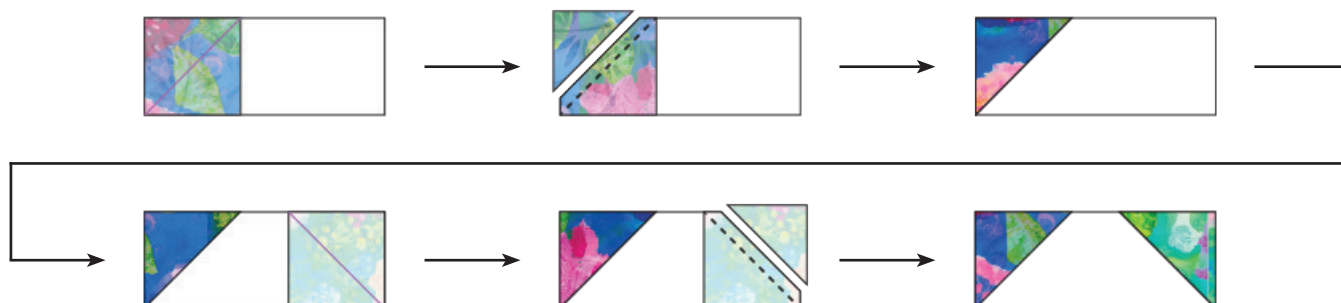

**Step 3:** Referring to the fabric placement and pairings in the Quilt Assembly Diagram, repeat Step 2 to make a total of eighteen units. These will be used around the outermost pieced edge of the quilt center.

**Step 4:** Place a 2" Fabric B square in the upper right corner of a 5" Fabric A square, right sides together. Note the orientation of the marked diagonal line. Sew on the marked line, then trim away the excess fabric, leaving a 1/4" seam allowance. Press. Repeat on the remaining corners of the 5" square.

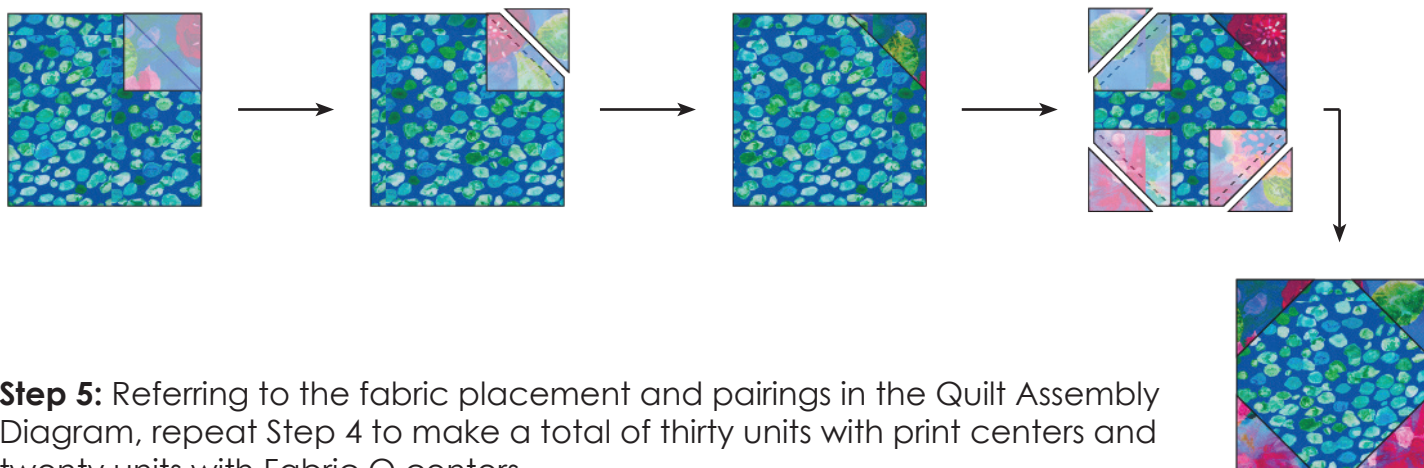

**Step 5:** Referring to the fabric placement and pairings in the Quilt Assembly Diagram, repeat Step 4 to make a total of thirty units with print centers and twenty units with Fabric Q centers.

## Assemble the Pieced Units

**Step 6:** Sew a 2" Fabric B square to opposite edges of a 2" Fabric Q square. Press away from Fabric Q.

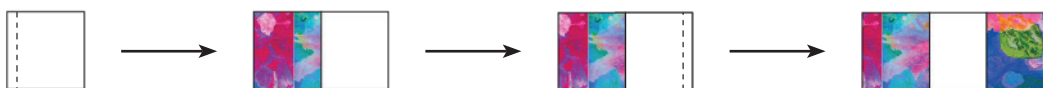

**Step 7:** Referring to the fabric placement and pairings in the Quilt Assembly Diagram, repeat Step 6 to make a total of twenty-two units, each for the outside edge of the quilt.

**Step 8:** Referring to the fabric placement and pairings in the Quilt Assembly Diagram, repeat Step 6 to make a total of ninety-eight units, each for the inner portion of the quilt center. Note that some of these units will be made from the same fabrics on either side of the Q square, but that some units will be made with different fabrics on either side of the Q square. It is best to organize your finished pieces by row, in piles, for easier sewing later.

**Step 9:** Referring to the Quilt Assembly Diagram for fabric pairings and placement, gather two units from Step 8 and one 2" x 5" Fabric Q rectangle. Sew together as shown and press away from the Q rectangle.

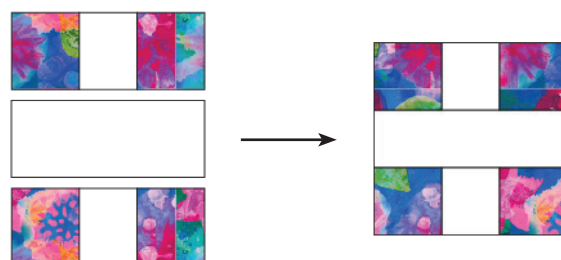

**Step 10:** Referring to the fabric placement and pairings in the Quilt Assembly Diagram, repeat Step 9 to make a total of forty-nine units.



## Assemble the Quilt

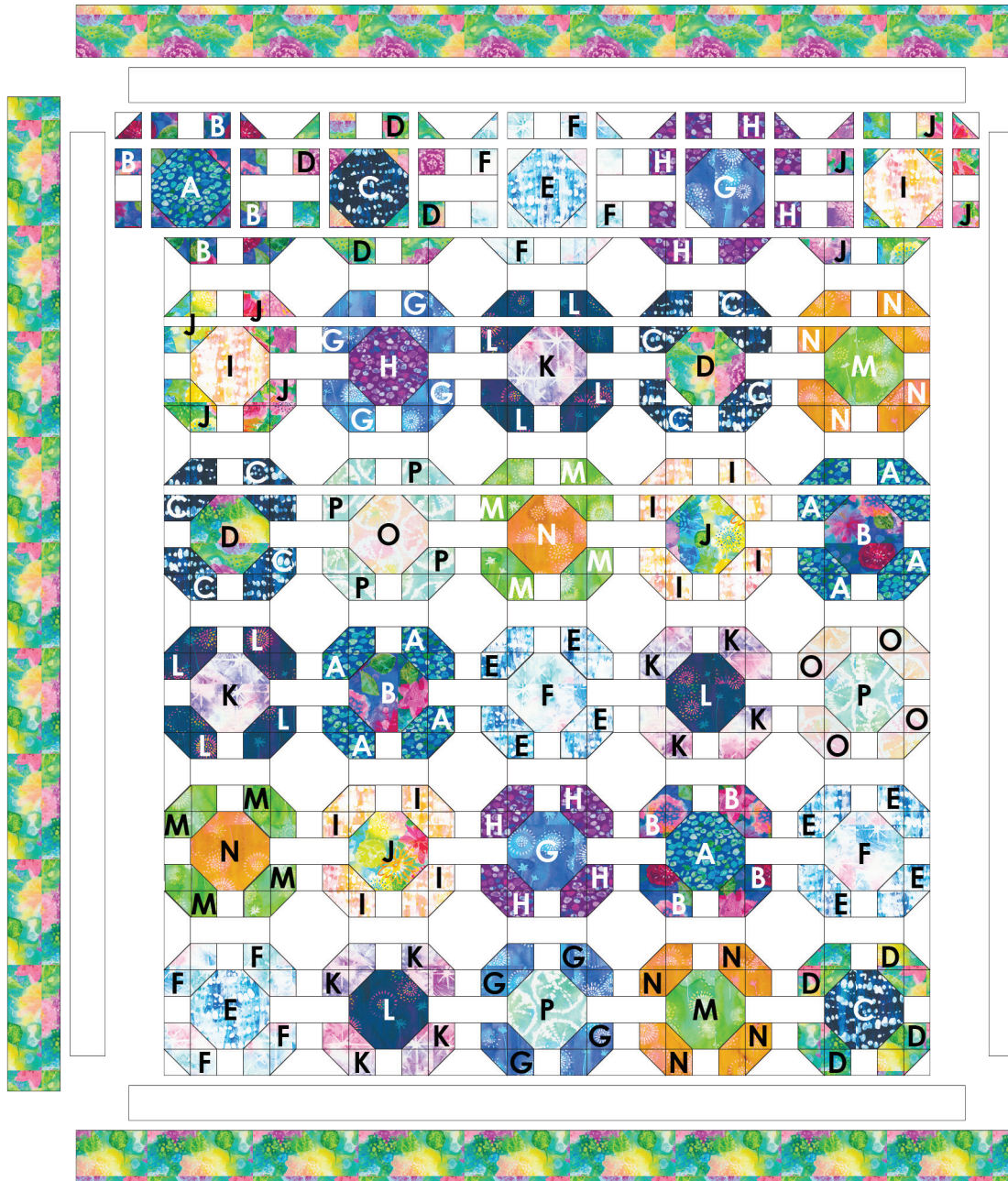

### Step 11:

Arrange the HSTs, stitch-and-flip, and pieced units into rows as shown. Note the fabric placement and block orientation in the Quilt Assembly Diagram.

**Step 12:** Sew the units together to form rows. Press the seams away from the stitch and flip units.

**Step 13:** Sew the rows together to form the quilt center. Press the row seams open.

**Step 14:** Sew the side inner borders to the sides of the quilt center. Press toward the borders. Sew the top and bottom inner borders to the quilt center. Press toward the borders.

**Step 15:** Sew the side outer borders to the sides of the quilt center. Press toward the borders. Sew the top and bottom outer borders to the quilt center. Press toward the borders.

Your quilt top is complete! Baste, quilt, bind and enjoy!

This pattern may be used for personal purposes only and may not be reproduced in any form without the express permission from Robert Kaufman Fabrics. This pattern is not for resale. All patterns, unless otherwise attributed, are © Robert Kaufman Co., Inc. 2005-2021. All rights reserved.