

MINI PETALS

Designed by Robert Kaufman Fabrics Featuring
www.robertkaufman.com



Finished quilt measures: 52" x 61"

Difficulty Rating: **Beginner**

ROBERTKAUFMAN
F A B R I C S

For questions about this pattern, please email Patterns@RobertKaufman.com.

Fabric and Supplies Needed

Fabric amounts based on yardage that is 42" wide.

Color	Fabric	Name/SKU	Yardage	Color	Fabric	Name/SKU	Yardage
		JCHS-1416-127	1 Jumbo Charm Square Pack		B	FLHD-24147-391	5/8 yard
	A	K001-1387 WHITE	1-1/3 yards		Binding	FLHD-24148-77	1/2 yard
Copyright 2020, Robert Kaufman For individual use only - Not for resale				You will also need: 3-1/3yards for backing			

Notes Before You Begin

- Read through all of the instructions before beginning.
- All of the seam allowances are 1/4" unless otherwise noted.
- Press seam allowances open unless otherwise noted.
- Width of fabric (WOF) is equal to at least 42" wide.
- Right sides together has been abbreviated to RST.
- Remember to measure twice and cut once!

Cutting Instructions

From Fabric A, cut:

fifteen 2-1/2" x WOF strips. Subcut:

two hundred and forty 2-1/2" squares.

On the back of each square, mark a line along the diagonal.

five 1-1/2" x WOF strips. Sew together, end-to-end, then trim:

two 1-1/2" x 54-1/2" side inner borders

two 1-1/2" x 47-1/2" top/bottom inner borders

From Fabric B, cut:

six 3" x WOF strips. Sew together, end-to-end, then trim:

two 3" x 56-1/2" side outer borders

two 3" x 52-1/2" top/bottom outer borders

From the Binding Fabric, cut:

six 2-1/2" x WOF strips

Assemble the Blocks

Step 1: Place a 2-1/2" Fabric A square in the upper right corner of a 5" print square, right sides together. Note the orientation of the marked diagonal line. Sew on the marked line, then trim away the excess fabric, leaving a 1/4" seam allowance. Press. Repeat on the lower left corner with another 2-1/2" Fabric A square. Repeat to make a total of one hundred and twenty Blocks, each 5" square.

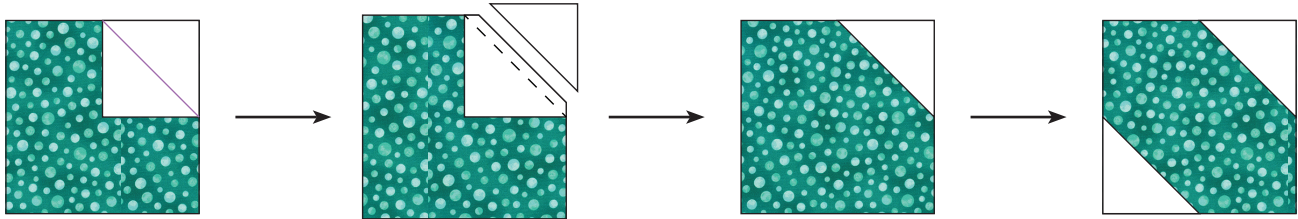

Assemble the Quilt

Step 2: Arrange the blocks into twelve rows of ten blocks. Note the block orientation in the Quilt Assembly Diagram.

Step 3: Sew the blocks together to form rows. Press the rows to the left in the odd numbered rows and to the right in the even numbered rows.

Step 4: Sew the rows together to form the quilt center. Press the row seams open.

Step 5: Sew the side inner borders to the sides of the quilt center. Press toward the borders. Sew the top and bottom inner borders to the quilt center. Press toward the borders.

Step 6: Sew the side outer borders to the sides of the quilt center. Press toward the borders. Sew the top and bottom outer borders to the quilt center. Press toward the borders.

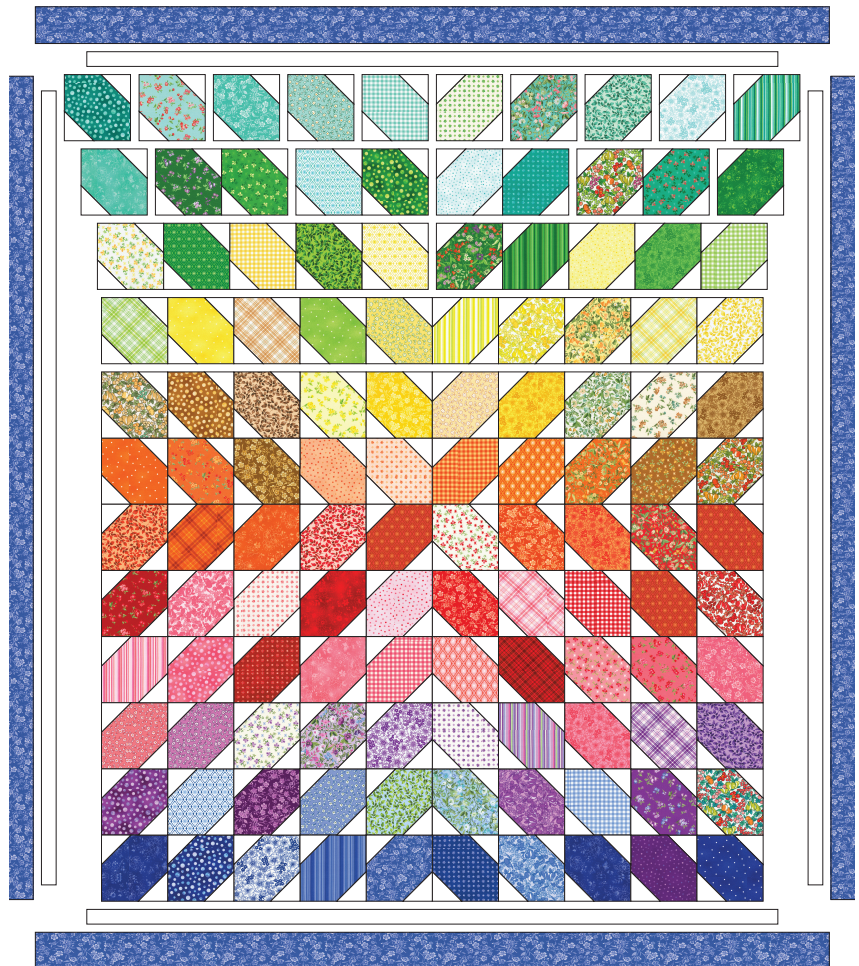

Your quilt top is complete! Baste, quilt, bind and enjoy!

This pattern may be used for personal purposes only and may not be reproduced in any form without the express permission from Robert Kaufman Fabrics. This pattern is not for resale. All patterns, unless otherwise attributed, are © Robert Kaufman Co., Inc. 2005-2026. All rights reserved.