

# COLOR CASCADE

Designed by Ariga Wilson for RK  
[www.robertkaufman.com](http://www.robertkaufman.com)

Featuring ARTISAN **Tranquil Gardens**™

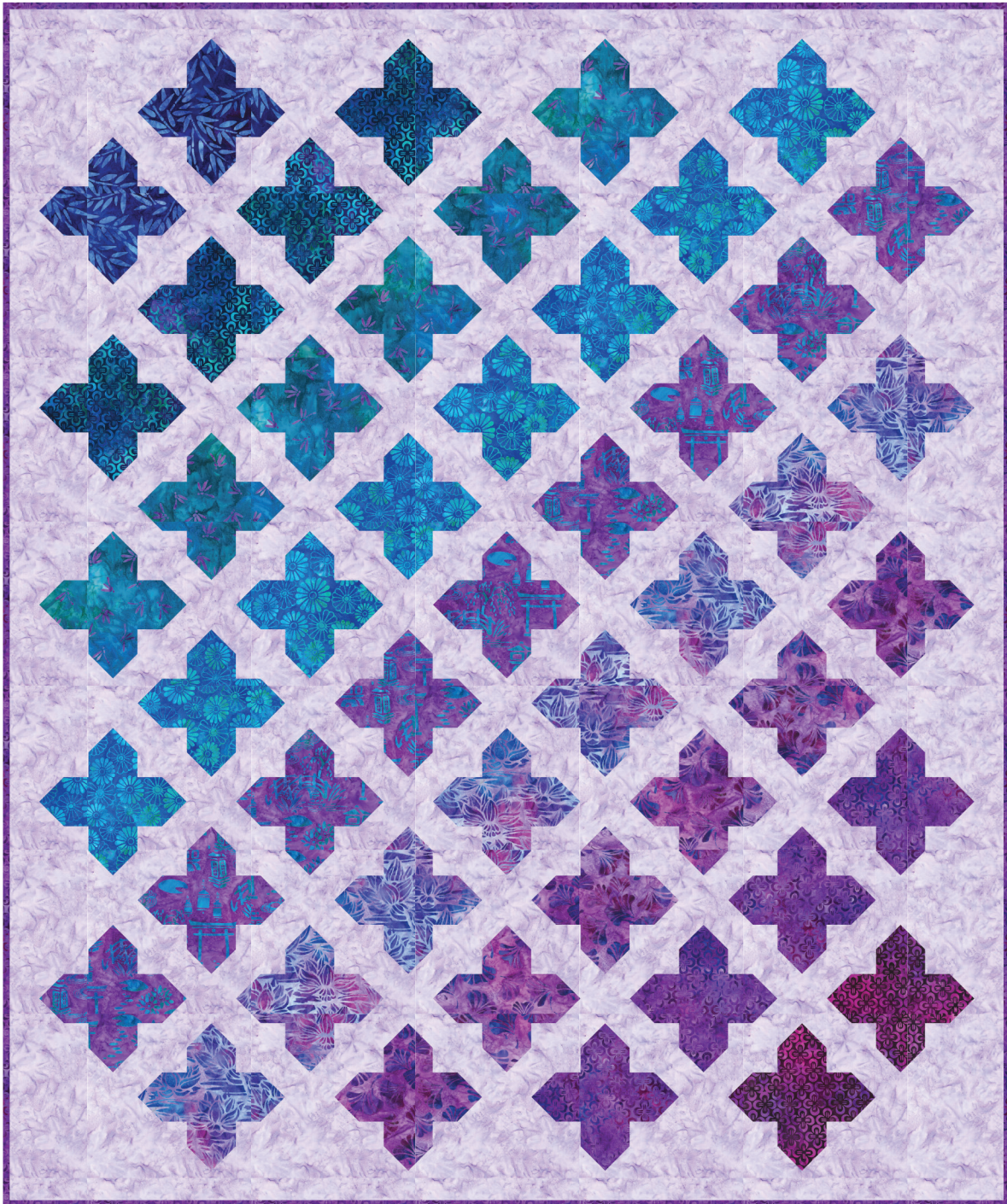

Finished quilt measures: 61" x 73-1/2"







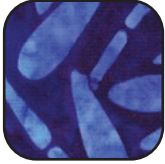

Difficulty Rating: **Beginner**

**ROBERTKAUFMAN**  
F A B R I C S

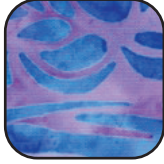
For questions about this pattern, please email [Patterns@RobertKaufman.com](mailto:Patterns@RobertKaufman.com).

## Fabric and Supplies Needed

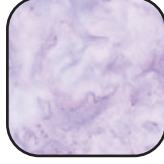
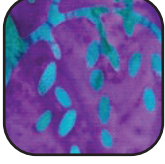
*Fabric amounts based on yardage that is 42" wide.*

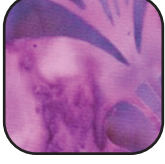
Color	Fabric	Name/SKU	Yardage	Color	Fabric	Name/SKU	Yardage
	A	AMD-21833-62 INDIGO	1/8 yard		G	AMD-21832-24 PLUM	1/3 yard
	B	AMD-21832-78 PEACOCK	1/4 yard		H	AMD-21831-61 PERIWINKLE	1/4 yard
	C	AMD-21834-78 PEACOCK	1/3 yard		I	AMD-21832-25 EGGPLANT	1/8 yard
	D	AMD-21829-246 WATER	1/2 yard		J	AMD-7000-23 LAVENDER	3-1/8 yards
	E	AMD-21830-19 ORCHID	1/2 yard		Binding*	AMD-21832-24 PLUM	5/8 yard
	F	AMD-21835-24 PLUM	1/2 yard	You will also need: 3-1/2 yards for backing			
Copyright 2023, Robert Kaufman For individual use only - Not for resale							

### Notes Before You Begin

- Read through all of the instructions before beginning.
- All of the seam allowances are 1/4" unless otherwise noted.
- Press seam allowances open unless otherwise noted.
- Width of fabric (WOF) is equal to at least 42" wide.
- Right sides together has been abbreviated to RST.
- Remember to measure twice and cut once!



## Cutting Instructions

### **From each of Fabrics A and I, cut:**

one 3-1/2" x WOF strip. Subcut:  
two 3-1/2" x 9-1/2" rectangles  
four 3-1/2" squares

### **From each of Fabrics B and H, cut:**

two 3-1/2" x WOF strips. Subcut:  
four 3-1/2" x 9-1/2" rectangles  
eight 3-1/2" squares

### **From each of Fabrics C and G, cut:**

three 3-1/2" x WOF strips. Subcut:  
six 3-1/2" x 9-1/2" rectangles  
twelve 3-1/2" squares

### **From each of Fabrics D and F, cut:**

four 3-1/2" x WOF strips. Subcut:  
eight 3-1/2" x 9-1/2" rectangles  
sixteen 3-1/2" squares

### **From Fabric E, cut:**

five 3-1/2" x WOF strips. Subcut  
nine 3-1/2" x 9-1/2" rectangles  
eighteen 3-1/2" squares

### **From Fabric J, cut:**

sixteen 3-1/2" x WOF strips. Subcut:  
ten 3-1/2" x 9-1/2" rectangles  
twelve 3-1/2" x 6-1/2" rectangles  
one hundred and thirty-eight 3-1/2" squares  
seven 2-1/2" x WOF strips. Sew together, end-to-end, then trim:  
two 2-1/2" x 69-1/2" side outer borders  
two 2-1/2" x 61-1/2" top/bottom outer borders  
nineteen 2" x WOF strips. Subcut:  
three hundred and ninety-two 2" squares

### **From the Binding Fabric, cut:**

eight 2-1/2" x WOF strips

## Stitch and Flip Note

Each of the 2" Fabric J squares are used for the Stitch and Flip technique. You can mark a diagonal line on the back of each square, OR you can simply eyeball this line if you are comfortable with that method.

### Assemble the Square Stitch and Flip Units

**Step 1:** Place a 2" Fabric J square in the upper right corner of a 3-1/2" Fabric A square, right sides together. Note the orientation of the marked diagonal line. Sew on the marked line, then trim away the excess fabric, leaving a 1/4" seam allowance. Press.

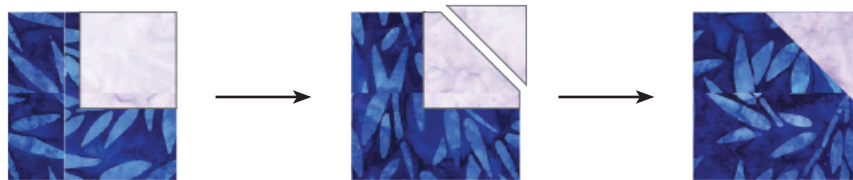

Repeat on the upper left corner with another 2" Fabric J square.



**Step 2:** Repeat Step 1 for all remaining 3-1/2" squares from Fabrics A-I.

### Assemble the Rectangle Stitch and Flip Units

**Step 3:** Place a 2" Fabric J square in the upper right corner of a 3-1/2" x 9-1/2" Fabric A rectangle, right sides together. Note the orientation of the marked diagonal line. Sew on the marked line, then trim away the excess fabric, leaving a 1/4" seam allowance. Press.



Repeat on the remaining three corners with 2" Fabric J squares.

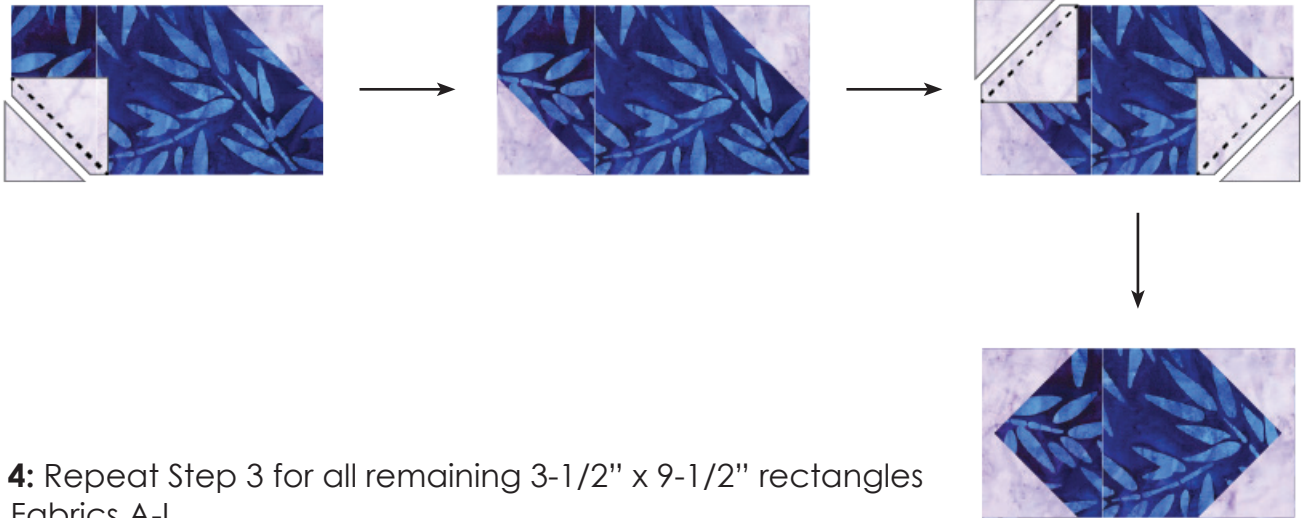

**Step 4:** Repeat Step 3 for all remaining 3-1/2" x 9-1/2" rectangles from Fabrics A-I.

## Assemble the Quilt

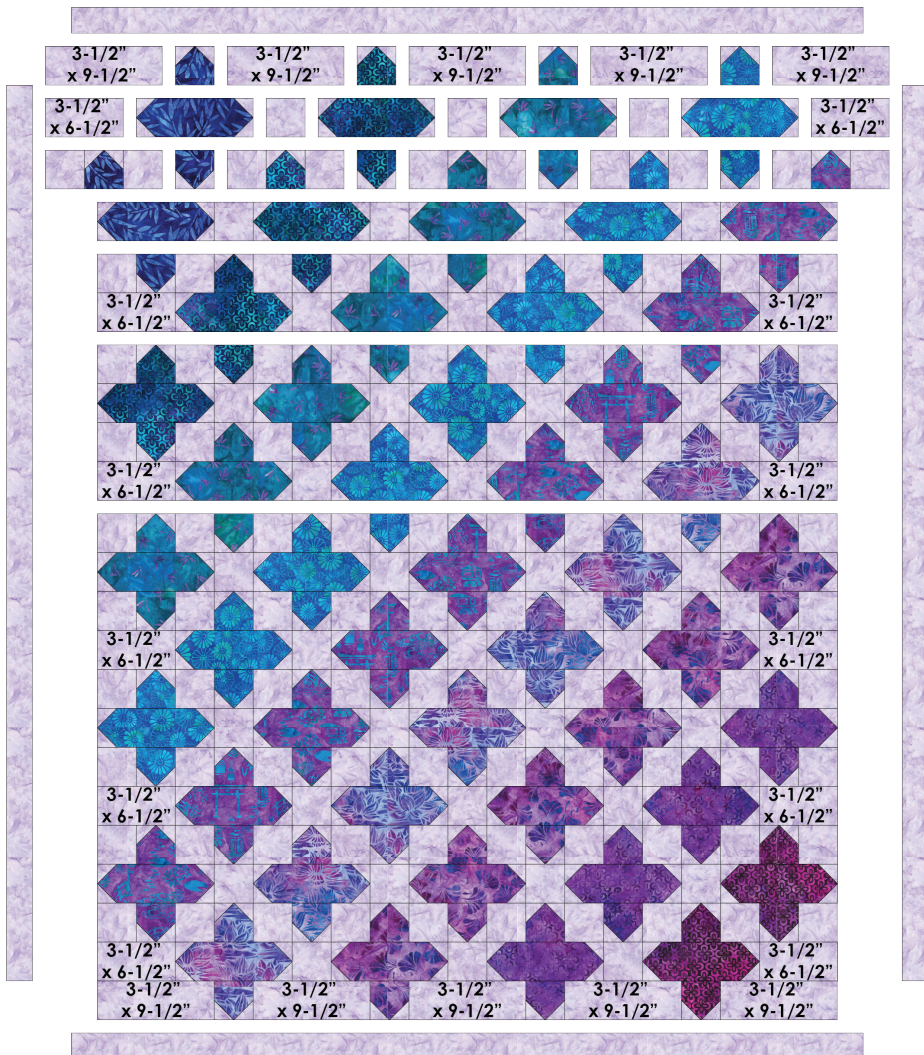

**Step 5:** Arrange the blocks into rows, as shown. Note the fabric placement and block orientation in the Quilt Assembly Diagram.

**Step 6:** Sew the blocks together to form rows. Press the seams toward the Fabric I squares and rectangles.

**Step 7:** Sew the rows together to form the quilt center. Press the row seams open.

**Step 8:** Sew the side outer borders to the sides of the quilt center. Press toward the borders. Sew the top and bottom outer borders to the quilt center. Press toward the borders.

Your quilt top is complete!  
Baste, quilt, bind and enjoy!

This pattern may be used for personal purposes only and may not be reproduced in any form without the express permission from Robert Kaufman Fabrics. This pattern is not for resale. All patterns, unless otherwise attributed, are © Robert Kaufman Co., Inc. 2005-2023. All rights reserved.