

COLLAGE

Designed by Ariga Mahmoudlou for RK
www.robertkaufman.com

Featuring **WAREHOUSE
DISTRICT** A *Wishwell* Collection
by LESLIE TUCKER JENISON



Finished quilt measures: 54" x 65"

Difficulty Rating: **Beginner**

ROBERTKAUFMAN
F A B R I C S

For questions about this pattern, please email Patterns@RobertKaufman.com.

Fabric and Supplies Needed

Fabric amounts based on yardage that is 42" wide.

Color	Fabric	Name/SKU	Yardage	Color	Fabric	Name/SKU	Yardage
	A	ANJ-19791-265 PARCHMENT	2-1/3 yards		I	ANJ-19789-200 VINTAGE	1/4 yard
	B	ANJ-19789-179 RUST	1/4 yard		J	ANJ-19790-119 MAUVE	1/4 yard
	C	ANJ-19793-221 AUBERGINE	1/4 yard		K	ANJ-19791-425 AQUAMARINE	1/4 yard
	D	ANJ-19791-141 SAFFRON	1/4 yard		L	ANJ-19792-184 CHARCOAL	1/4 yard
	E	ANJ-19792-138 HONEY	1/4 yard		M	ANJ-19793-69 MIDNIGHT	1/3 yard
	F	ANJ-19792-43 LEAF	1/4 yard		N	ANJ-19790-70 AQUA	1/3 yard
	G	ANJ-19793-59 OCEAN	1/4 yard		O	ANJ-19790-135 MUSTARD	1/3 yard
	H	ANJ-19789-248 MARINE	1/4 yard		Binding*	ANJ-19793-69 MIDNIGHT	5/8 yard
<p>Copyright 2020, Robert Kaufman For individual use only - Not for resale</p>				<p>You will also need: 3-1/2 yards for backing</p>			

**Also used for Fabric M*

Notes Before You Begin

- Read through all of the instructions before beginning.
- All of the seam allowances are 1/4" unless otherwise noted.
- Press seam allowances open unless otherwise noted.
- Width of fabric (WOF) is equal to at least 42" wide.
- Right sides together has been abbreviated to RST.
- Remember to measure twice and cut once!

Cutting Instructions

From Fabric A, cut:

twenty-three 3-1/2" x WOF strips. Subcut:

ninety 3-1/2" x 7" rectangles

ninety 3-1/2" squares. Mark a diagonal on the back side of each square.

From each of Fabrics B-L, cut:

two 3-1/2" x WOF strips. Subcut:

six 3-1/2" x 7" rectangles

six 3-1/2" squares. Mark a diagonal on the back side of each square.

From each of Fabrics M-O, cut:

three 3-1/2" x WOF strips. Subcut:

eight 3-1/2" x 7" rectangles

eight 3-1/2" squares. Mark a diagonal on the back side of each square.

From the Binding Fabric, cut:

seven 2-1/2" x WOF strips

Assemble the Blocks

Step 1: Gather

two Fabric A rectangles

two Fabric A squares

two Fabric B rectangles

two Fabric B squares

Note: Fabric A will now be referred to as the Background Fabric, and Fabrics B-O will be referred to as the Print Fabrics.

Step 2: Place a Background square at the top edge of a Print rectangle, right sides together. Note the orientation of the marked diagonal line. Sew on the marked line, then trim away the excess fabric, leaving a 1/4" seam allowance. Press. Repeat to make a second unit like this.

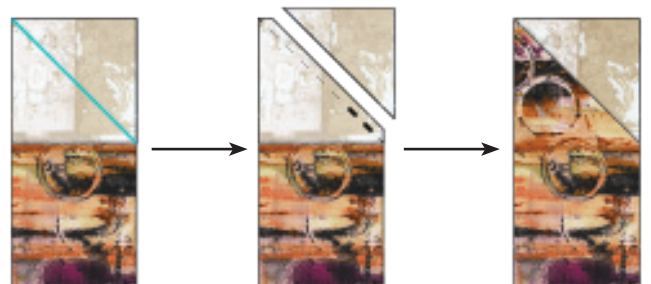

Step 3: Place a Print square at the top edge of a Background rectangle, right sides together. Note the orientation of the marked diagonal line and how it is the mirror image of the marked line in Step 2. Sew on the marked line, then trim away the excess fabric, leaving a 1/4" seam allowance. Press. Repeat to make a second unit like this.

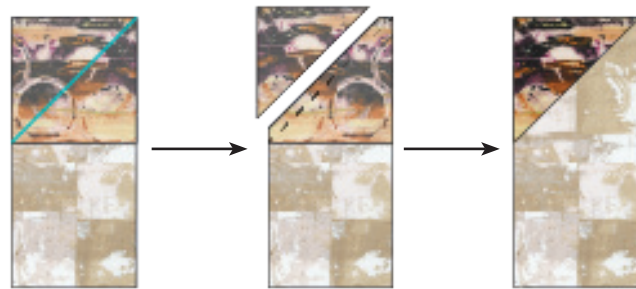

Step 4: Arrange the units into two rows of two. Note the fabric placement and orientation in the Block Assembly Diagram.

Step 5: Sew the units together to form the rows. Press the seams to the left in the top row and to the right in the bottom row.

Step 6: Sew the rows together, nesting the seams and pressing the seams to one side to form the block.



The Block should measure 6-1/2" x 13-1/2". Repeat to make:
three Blocks from each of Fabrics B-L
four Blocks from each of Fabrics M-O

Assemble the Quilt

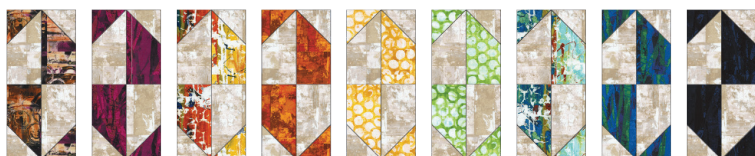

Step 7: Arrange the blocks into five rows of nine Blocks. Note the fabric placement and block orientation in the Quilt Assembly Diagram.



Step 8: Sew the blocks together to form rows. Press the rows to the left in the odd numbered rows and to the right in the even numbered rows.



Step 9: Sew the rows together to form the quilt center. Press the row seams open.



Your quilt top is complete! Baste, quilt, bind and enjoy!