

CELEBRATION RUNNER

Designed by Ariga Wilson for RK
www.robertkaufman.com

Featuring *Festive Fauna*



Finished quilt measures: 24" x 68"













Difficulty Rating: **Beginner**

ROBERTKAUFMAN
F A B R I C S

For questions about this pattern, please email Patterns@RobertKaufman.com.

Fabric and Supplies Needed

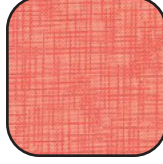
Fabric amounts based on yardage that is 42" wide.

Color	Fabric	Name/SKU	Yardage	Color	Fabric	Name/SKU	Yardage
	A	AHPD-23041-223 HOLIDAY	2/3 yard (one full panel)		H	AHPD-23046-94 CARDINAL	1/8 yard
	B	AHPD-23047-91 CRIMSON	1/8 yard		I	AHPD-23043-113 CRANBERRY	1/8 yard
	C	AHPD-23044-224 EVERGREEN	1/8 yard		J	AHPD-23045-91 CRIMSON	1/8 yard
	D	AHPD-23048-270 MEADOW	1/8 yard		K	AHPD-23045-240 HOLLY	1/4 yard
	E	ETJ-9864-224 EVERGREEN	1/4 yard		L	AHPD-23048-14 NATURAL	5/6 yard
	F	ETJ-9864-420 CLOVER	1/4 yard		Binding	ETJ-9864-143 CORAL	3/8 yard
	G	AHPD-23048-478 CANDY CANE	1/8 yard	<div>You will also need: 2 yards for backing</div>			
Copyright 2025, Robert Kaufman For individual use only - Not for resale							

Notes Before You Begin

- Read through all of the instructions before beginning.
- All of the seam allowances are 1/4" unless otherwise noted.
- Press seam allowances open unless otherwise noted.
- Width of fabric (WOF) is equal to at least 42" wide.
- Right sides together has been abbreviated to RST.
- Remember to measure twice and cut once!

Cutting Instructions

From Fabric A, fussy cut:

five 9-1/2" squares

From each of Fabrics B and C, cut:

two 1-1/2" x WOF strips. Subcut:

four 1-1/2" x 9-1/2" side block borders

four 1-1/2" x 11-1/2" top/bottom block borders

*cut two of each length from each strip to maximize yardage

From Fabric D, cut:

one 1-1/2" x WOF strip. Subcut:

two 1-1/2" x 9-1/2" side block borders

two 1-1/2" x 11-1/2" top/bottom block borders

From Fabric E, cut:

four 1-1/2" x WOF strips. Sew together, end-to-end, then trim:

two 1-1/2" x 55-1/2" side inner borders

two 1-1/2" x 13-1/2" top/bottom inner borders

From Fabric F, cut:

four 2" x WOF strips. Sew together, end-to-end, then trim:

two 2" x 57-1/2" side middle borders

two 2" x 16-1/2" top/bottom middle borders

From each of Fabrics G and H, cut:

one 2-1/2" x WOF strip. Subcut:

six 2-1/2" x 4-1/2" rectangles for the flying geese

From each of Fabrics I and J, cut:

one 2-1/2" x WOF strip. Subcut:

eight 2-1/2" x 4-1/2" rectangles for the flying geese

From Fabric K, cut:

two 2-1/2" x WOF strips. Subcut:

twelve 2-1/2" x 4-1/2" rectangles for the flying geese

From Fabric L, cut:

three 4-1/2" x WOF strips. Subcut

two 4-1/2" x 34-1/2" side outer borders

two 4-1/2" x 10-1/2" top/bottom outer borders

five 2-1/2" x WOF strips. Subcut:

eighty 2-1/2" squares for the flying geese

From the Binding, cut:

five 2-1/2" x WOF strips.

Assemble the Flying Geese

Step 1: Place a 2-1/2" Fabric L square RST at one end of a Fabric G rectangle. Mark a diagonal line on the wrong side of the square, as shown. Sew on the marked line and trim away the excess fabric, leaving a 1/4" seam allowance. Press toward the triangle.

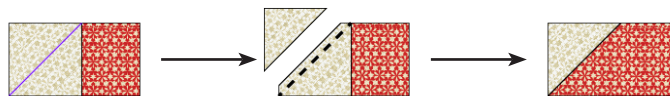

Step 2: Repeat Step 1 at the remaining end of the rectangle. The resulting flying geese block should measure 2-1/2" x 4-1/2".

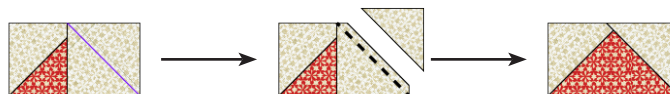

Step 3: Repeat with all remaining Fabric G-K rectangles.

Assemble the Outer Borders

Step 4: Gather:

four Fabric K Flying Geese

two Fabric J Flying Geese

one Fabric I Flying Geese

one 4-1/2" x 10-1/2" Fabric L border



Arrange the units into one row, as shown. Note the fabric placement and block orientation in the Border Assembly Diagram.

Step 5: Sew the units together to form the border. Press the seams toward the Fabric L rectangle. Repeat to make a second border like this. These are the top/bottom outer border units.

Step 6: Gather:

two Fabric K Flying Geese
two Fabric J Flying Geese
three Fabric I Flying Geese
three Fabric H Flying Geese
three Fabric G Flying Geese
one 4-1/2" x 34-1/2" Fabric L border



Arrange the units into one row, as shown. Note the fabric placement and block orientation in the Border Assembly Diagram.

Step 7: Sew the units together to form the border. Press the seams toward the Fabric L rectangle. Repeat to make a second border like this. These are the side outer border units.

Assemble the Blocks

Step 8: Sew the side block borders to the sides of a Fabric A square. Press toward the borders. Sew the top and bottom block borders to the unit. Press toward the borders. Make five Blocks, each measuring 11-1/2" square.

Note: Pair the B-D fabrics with specific Fabric A squares, as shown.



Assemble the Table Runner



Step 9: Arrange the blocks into one column. Note the fabric placement and block orientation in the Quilt Assembly Diagram.

Step 10: Sew the blocks together to form the column/quilt center. Press the seams to one side.

Step 11: Sew the side inner borders to the sides of the quilt center. Press toward the borders. Sew the top and bottom inner borders to the quilt center. Press toward the borders.

Step 12: Sew the side middle borders to the sides of the quilt center. Press toward the borders. Sew the top and bottom middle borders to the quilt center. Press toward the borders.

Step 13: Sew the side outer borders to the sides of the quilt center. Press toward the borders. Sew the top and bottom outer borders to the quilt center. Press toward the borders.

Your table runner top is complete. Baste, quilt, bind and enjoy!