

# BRIGHTLY SO

Designed by Elise Lea for RK  
[www.robertkaufman.com](http://www.robertkaufman.com)

Featuring FLOWERHOUSE

## Brightly So

Debbie Beaves



Finished quilt measures: 67" x 85"









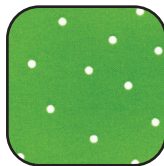
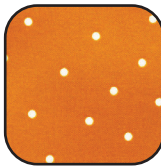

Difficulty Rating: **Intermediate**

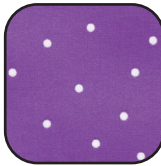
ROBERTKAUFMAN  
F A B R I C S

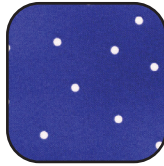
For questions about this pattern, please email [Patterns@RobertKaufman.com](mailto:Patterns@RobertKaufman.com).

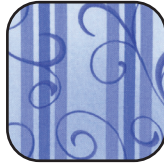
## Fabric and Supplies Needed

*Fabric amounts based on yardage that is 42" wide.*

Color	Fabric	Name/SKU	Yardage	Color	Fabric	Name/SKU	Yardage
	A	FLH-21173-14 NATURAL	2-1/2 yards		H	FLH-21175-7 GREEN	1/2 yard
	B	FLH-21175-8 ORANGE	3/8 yard		I	FLH-21171-4 BLUE	1-1/2 yards
	C	FLH-21175-22 VIOLET	3/8 yard		J	FLH-21173-8 ORANGE	1/2 yard
	D	FLH-21174-5 YELLOW	3/8 yard		K	FLH-21175-4 BLUE	1/3 yard
	E	FLH-21170-14 NATURAL	1/2 yard		L	FLH-21176-4 BLUE	1/3 yard
	F	FLH-21174-4 BLUE	1/2 yard		Binding*	FLH-21173-8 ORANGE	5/8 yard
	G	FLH-21171-5 YELLOW	1/2 yard			<i>*Also used for Fabric J</i>	
Copyright 2022, Robert Kaufman For individual use only - Not for resale				You will also need: 5-1/8 yards for backing			

## Notes Before You Begin

- Read through all of the instructions before beginning.
- All of the seam allowances are 1/4" unless otherwise noted.
- Press seam allowances open unless otherwise noted.
- Width of fabric (WOF) is equal to at least 42" wide.
- Right sides together has been abbreviated to RST.
- Remember to measure twice and cut once!

## Cutting Instructions

### **From Fabric A, cut:**

eleven 3" x WOF strips. Subcut:

one-hundred and forty-four 3" squares

three 2-1/2" x WOF strips. Subcut:

forty-eight 2-1/2" squares

twenty-six 1-1/2" x WOF strips. Subcut:

eight 1-1/2" x 17-1/2" vertical sashing strips

forty-eight 1-1/2" x 8-1/2" rectangles

Sew the remaining ten strips together end-to-end, then subcut:

three 1-1/2" x 53-1/2" horizontal sashing strips

two 1-1/2" x 71-1/2" side inner borders

two 1-1/2" x 55-1/2" top and bottom inner borders

### **From each of Fabrics B, C, and D, cut:**

four 3" x WOF strips. Subcut:

forty-eight 3" squares from each fabric

### **From each of Fabrics E-H, and J, cut:**

two 7" x WOF strips. Subcut:

eight 7" squares from each fabric

### **From Fabric I, cut:**

two 7" x WOF strips. Subcut:

eight 7" squares from each fabric

seven 5-1/2" x WOF strips. Sew the strips together end-to-end, then subcut:

two 5-1/2" x 75-1/2" side outer borders

two 5-1/2" x 67-1/2" top and bottom outer borders

### **From Fabric K, cut:**

three 2-1/2" x WOF strips. Subcut:

forty-eight 2-1/2" squares

one 1-1/2" x WOF strip. Subcut:

twelve 1-1/2" squares



**From Fabric L, cut:**

seven 1-1/2" x WOF strips. Sew the strips together end-to-end, then subcut:

two 1-1/2" x 73-1/2" side middle borders

two 1-1/2" x 57-1/2" top and bottom middle borders

**From Binding Fabric, cut:**

eight 2-1/2" x WOF strips

## Assemble the Half-Square Triangles (HSTs)

**Step 1:** Pair a 3" Fabric A square with a 3" Fabric B square, RST. Mark a diagonal line on the wrong side of one square. Sew 1/4" away from both sides of the marked line. Cut on the marked line creating two half-square triangles (HSTs). Press toward the darker fabric. Trim to 2-1/2" square. Repeat to make ninety-six A/B HSTs.



**Step 2:** Repeat step 1 to make:



ninety-six A/C HSTs



ninety-six A/D HSTs

**Step 3:** Pair a 7" Fabric E square with a 7" Fabric F square, RST. Mark a diagonal line on the wrong side of one square. Sew 1/4" away from both sides of the marked line. Cut on the marked line creating two half-square triangles (HSTs). Press toward the darker fabric. Trim to 6-1/2" square. Repeat to make sixteen E/F HSTs.

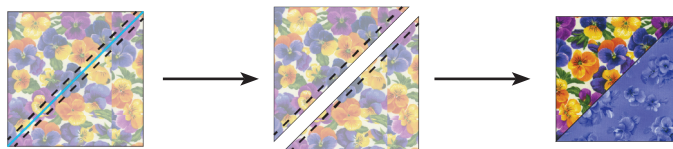

**Step 4:** Repeat step 3 to make:



sixteen G/H HSTs



sixteen I/J HSTs



## Flip and Stitch the Corners

**Step 5:** Place a 2-1/2" Fabric K square on the Fabric F corner of an E/F HST, RST. Mark a diagonal line on the wrong side of the Fabric K square. Sew on the marked line. Trim 1/4" away from the seam. Press toward the Fabric K corner. Repeat to make sixteen E/F/K units.

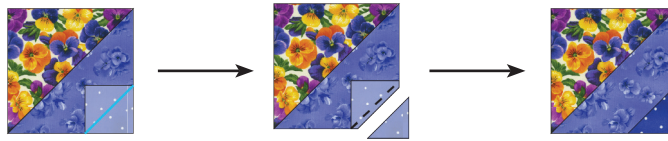

**Step 6:** Repeat step 5 to make:



sixteen G/H/K units



sixteen I/J/K units

## Assemble the Corner Units

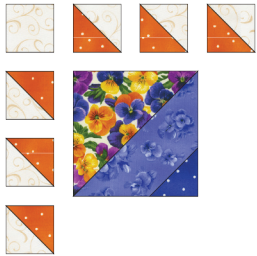

**Step 7:** Gather:  
one E/F/K unit  
six A/B HSTs  
one 2-1/2" Fabric A square

Arrange the units to form one corner unit of the block as shown.



**Step 8:** Sew the Fabric A square and 3 HSTs in the top row together and press.



**Step 9:** Sew the 3 HSTs along the left edge together to form a column. Press.



**Step 10:** Sew the step 9 column to the left edge of the E/F/K unit. Press.



**Step 11:** Sew the step 8 row to the top of the unit and press to form a corner unit.

**Step 12:** Repeat steps 7-11 to make sixteen A/B/E/F/K corner units.

**Step 13:** Repeat steps 7-11 to make corner units in the following fabric combinations:



sixteen A/C/G/H/K corner units

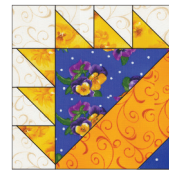

sixteen A/D/I/J/K corner units

## Assemble the Blocks

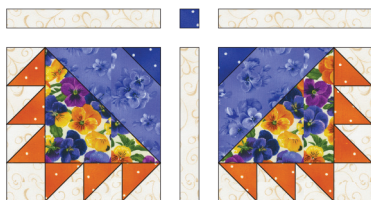
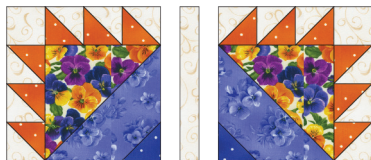

### Step 14: Gather:

four matching corner units  
four 1-1/2" x 8-1/2" Fabric A rectangles  
one 1-1/2" Fabric K squares

Arrange the units to form three rows of three units as shown.

**Step 15:** Sew the units together to form rows. Press the seams towards the Fabric A rectangles.

**Step 16:** Sew the rows together, nesting the seams and pressing the seams to one side to form the block. The block should measure 17-1/2" square.

**Step 17:** Repeat steps 14-16 to make:

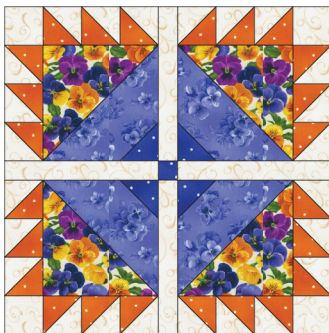

four A/B/E/F/K blocks.

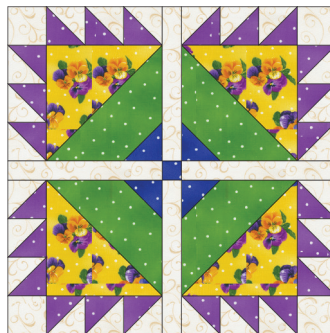

four A/C/G/H/K blocks

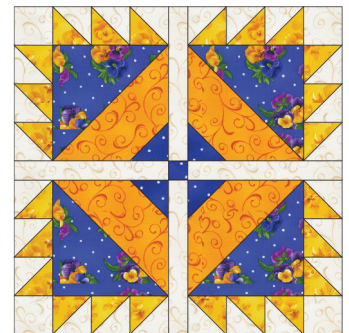

four A/D/I/J/K blocks

## Assemble the Quilt

**Step 18:** Arrange the blocks into four rows of three blocks. Note the block placement in the Quilt Assembly Diagram. Place a 1-1/2" x 17-1/2" sashing rectangle between the blocks. Sew the blocks and sashing rectangles together to form rows. Press the seams open.

**Step 19:** Place a 1-1/2" x 53-1/2" sashing strip between each of the rows. Sew the rows and sashing strips together to form the quilt center. Press the seams open.



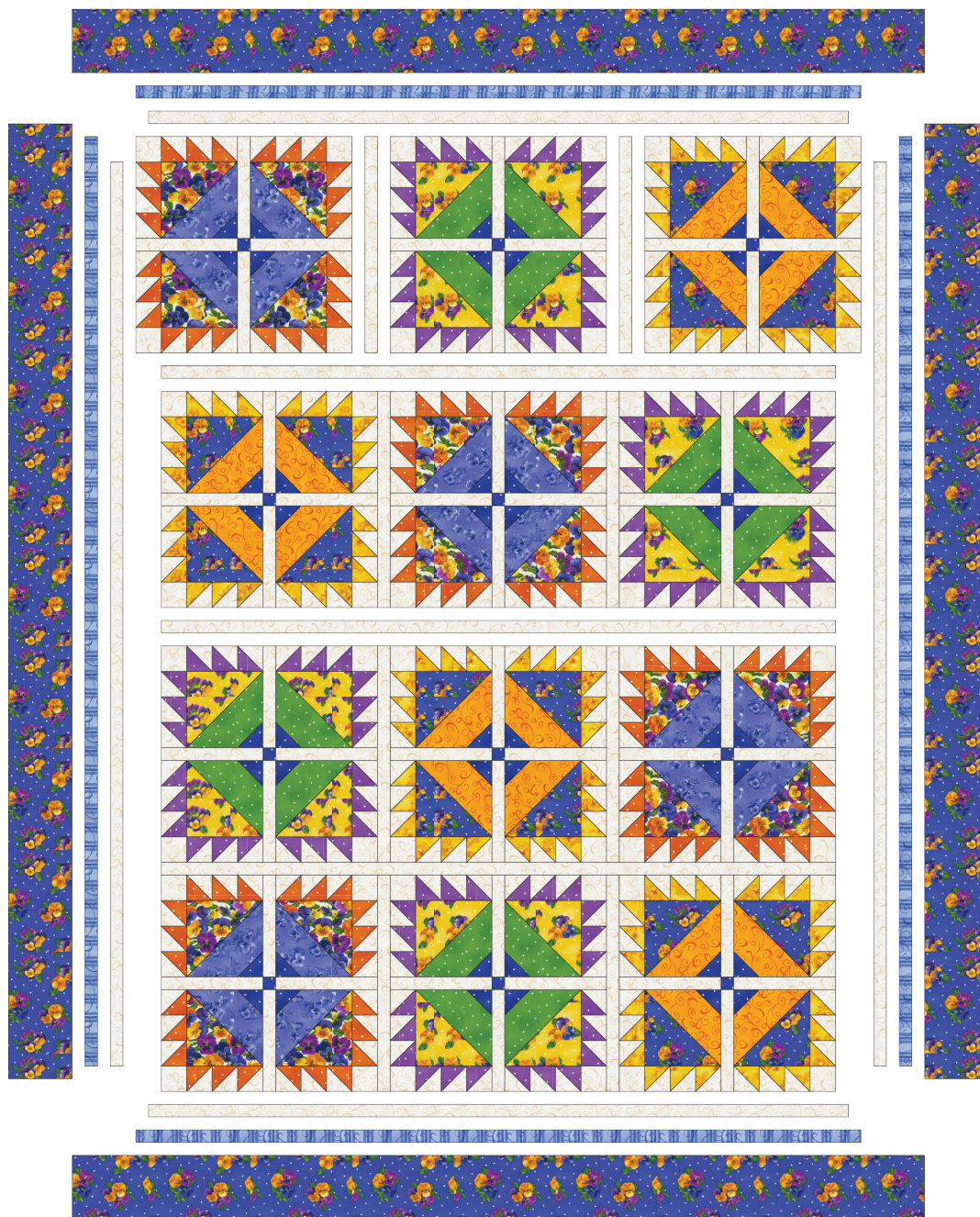

**Step 20:** Sew the side inner borders to the sides of the quilt center. Press toward the borders. Sew the top and bottom inner borders to the quilt center. Press toward the borders.

**Step 21:** Sew the side middle borders to the sides of the quilt center. Press toward the borders. Sew the top and bottom middle borders to the quilt center. Press toward the borders.

**Step 22:** Sew the side outer borders to the sides of the quilt center. Press toward the borders. Sew the top and bottom outer borders to the quilt center. Press toward the borders.

Your quilt top is complete! Baste, quilt, bind, and enjoy!

This pattern may be used for personal purposes only and may not be reproduced in any form without the express permission from Robert Kaufman Fabrics. This pattern is not for resale. All patterns, unless otherwise attributed, are © Robert Kaufman Co., Inc. 2005-2022. All rights reserved.