

WILDLIFE CITY

Designed by Ariga Mahmoudlou for RK Featuring **NORTH AMERICAN WILDLIFE**
www.robertkaufman.com



Finished quilt measures: 56" x 60-1/2"

Quilt shown in "DEER" colorstory. For alternate "FOX AND BEARS" colorstory see pages 7-8.

Difficulty Rating: **Intermediate**

ROBERTKAUFMAN
F A B R I C S

For questions about this pattern, please email Patterns@RobertKaufman.com.

Fabric and Supplies Needed

Fabric amounts based on yardage that is 42" wide.

Color	Fabric	Name/SKU	Yardage	Color	Fabric	Name/SKU	Yardage
	A	AJQD-18460-268 NATURE	2/3 yard (one full panel)		H	K001-1336 SLATE	1/8 yard
	B	ETJ-9864-184 CHARCOAL	1 yard		I	K001-1101 DELFT	1/8 yard
	C	ETJ-9864-156 LINEN	1-3/8 yard		J	K001-1058 CADET	1/8 yard
	D	K001-857 ROASTED PECAN	1/8 yard		K	K001-1389 WINDSOR	1/8 yard
	E	AJQD-18461-268 NATURE	1/4 yard		L	K001-1243 NAVY	1/8 yard
	F	K001-277 BLUEBERRY	1/8 yard		M	ETJ-9864-9 NAVY	1/4 yard
	G	K001-1123 DRESDEN BLUE	1/8 yard		Binding*	ETJ-9864-184 CHARCOAL <i>*Also used for Fabric B</i>	1/2 yard
Copyright 2018, Robert Kaufman For individual use only - Not for resale				You will also need: 3-3/4 yards for backing			

Notes Before You Begin

- Read through all of the instructions before beginning.
- All of the seam allowances are 1/4" unless otherwise noted.
- Press seam allowances open unless otherwise noted.
- Width of fabric (WOF) is equal to at least 42" wide.
- Right sides together has been abbreviated to RST.
- Remember to measure twice and cut once!

Cutting Instructions

From Fabric A, fussy cut:

one 23-1/2" x 43" center panel

From Fabric B, cut:

four 2-1/4" x WOF strips. Sew the strips together, then trim:

two 2-1/4" x 23-1/2" side Border 1 strips

two 2-1/4" x 46-1/2" top/bottom Border 1 strips

six 3-1/2" x WOF strips. Sew the strips together, then trim:

two 3-1/2" x 61" side Border 3 strips

two 3-1/2" x 50-1/2" top/bottom Border 3 strips

From Fabric C, cut:

two 3" x WOF strips. Subcut:

twenty-four 3" squares for the HSTs

sixteen 2-1/2" x WOF strips. Subcut:

ten 2-1/2" x 6-1/2" rectangles

ninety-two 2-1/2" squares for the flying geese

forty-eight 2-1/2" squares for the nine-patches

Sew the remaining five strips together, then trim:

two 2-1/2" x 55" side Border 2 strips

two 2-1/2" x 46-1/2" top/bottom Border 2 strips

From Fabric D, cut:

one 2-1/2" x WOF strips. Subcut:

twelve 2-1/2" squares

From Fabric E, cut:

two 3" x WOF strips. Subcut:

twenty-four 3" squares for the HSTs

From each of Fabrics F, G and I, cut:

one 2-1/2" x WOF strips. Subcut:

eight 2-1/2" x 4-1/2" rectangles for the flying geese

From each of Fabrics H, J and L cut:

one 2-1/2" x WOF strips. Subcut:

six 2-1/2" x 4-1/2" rectangles for the flying geese

From Fabric K cut:

one 2-1/2" x WOF strips. Subcut:
four 2-1/2" x 4-1/2" rectangles for the flying geese

From Fabric M, cut:

five 1-1/2" x WOF strips. Sew the strips together, then trim:
four 1-1/2" x 46-1/2" strips

From the Binding Fabric, cut:

six 2-1/2" x WOF strips

Assemble the Flying Geese

Step 1: Place a 2-1/2" Fabric C square RST at one end of a Fabric F rectangle. Mark a diagonal line on the wrong side of the square, as shown. Sew on the marked line and trim away the excess fabric, leaving a 1/4" seam allowance. Press toward the triangle.

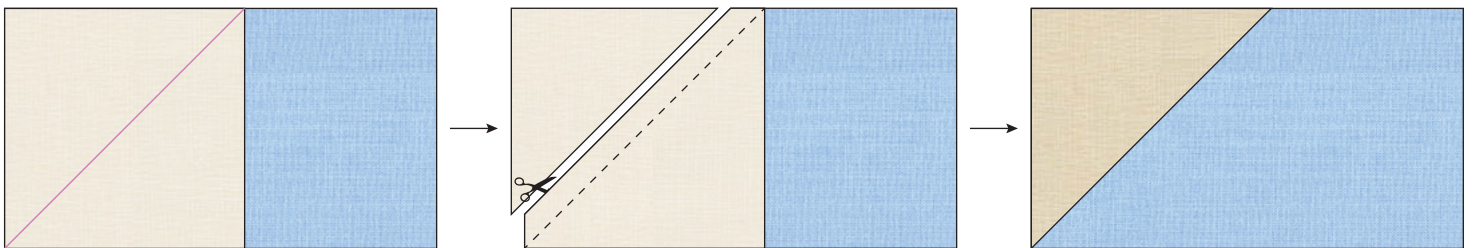

Step 2: Repeat Step 1 at the remaining end of the rectangle. The resulting flying geese block should measure 2-1/2" x 4-1/2".

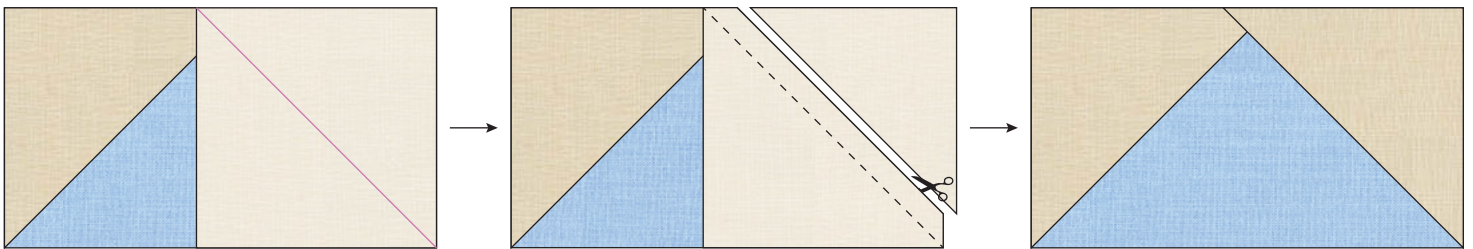

Step 3: Repeat with all remaining Fabric F-L rectangles.

Assemble the Nine-Patch Blocks

Step 4: Pair a 3" Fabric C square with a 3" Fabric E square, RST. Mark a diagonal line on the wrong side of one square. Sew 1/4" away from both sides of the marked line. Cut on the marked line, creating two half-square triangles (HSTs). Press toward the darker fabric. Trim to 2-1/2" square. Repeat to make forty-eight C/E HSTs.



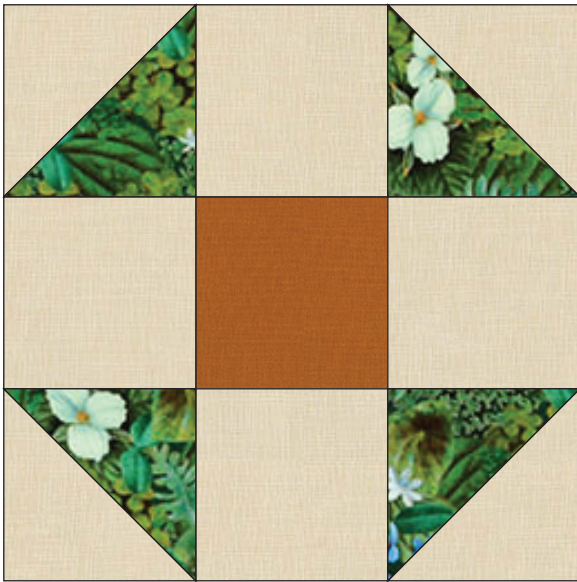

Step 5: Gather:
 four C/E HSTs
 four Fabric C squares
 one Fabric D square

Arrange the units into three rows of three. Note the fabric placement and block orientation in the Block Assembly Diagram.

Step 6: Sew the squares together to form the block. Press the seams toward the Fabric C squares.

Step 7: Sew the rows together, nesting the seams and pressing the seams to one side to form the block.

The resulting Nine-Patch Block should measure 6-1/2" square. Repeat to make twelve Nine-Patch Blocks.

Assemble the Rows

Step 8: Gather:
 four Fabric F flying geese
 four Fabric G flying geese
 three Fabric H flying geese
 four Fabric I flying geese
 three Fabric J flying geese
 two Fabric K flying geese
 three Fabric L flying geese

Sew together, in that order, along the longest edge and referring to the illustration as needed. Press the seams toward the Fabric F units.



Step 9: Sew a Fabric M strip to the top and bottom edges of the row. This is Row 1.

Repeat Steps 8 and 9 to make a second row like this. This is Row 4.

Step 10: Gather:
 six Nine-Patch blocks
 five 2-1/2" x 6-1/2" Fabric C rectangles

Sew together to form a row, placing a Fabric C rectangle between each block. Press the seams toward the Fabric C rectangles.

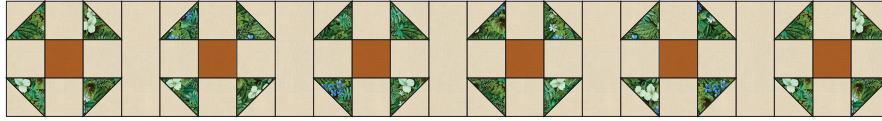

Repeat to make a second row like this. These are Rows 2 and 3.

Assemble the Quilt

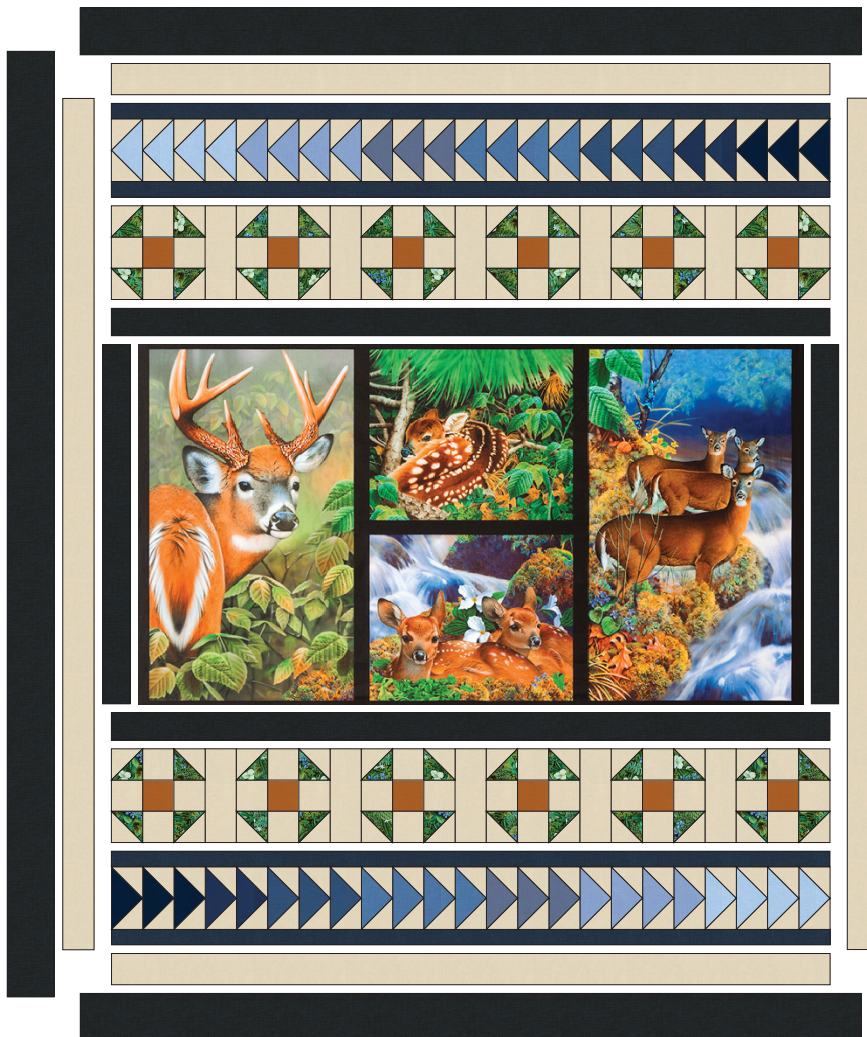

Step 11: Sew the side Border 1 pieces to the sides of the Fabric A quilt center. Press toward the borders. Sew the top and bottom Border 1 pieces to the quilt center. Press toward the borders.

Step 12: Sew together, in this order: Row 1 - Row 2 - Quilt Center from Step 11 - Row 3 - Row 4. Press the seams to one side.

Step 13: Sew the top and bottom Border 2 pieces to the quilt. Press toward the borders. Sew the side Border 2 pieces to the sides of the quilt. Press toward the borders.

Step 14: Sew the top and bottom Border 3 pieces to the quilt. Press toward the borders. Sew the side Border 3 pieces to the sides of the quilt. Press toward the borders.















Your quilt top is complete. Baste, quilt, bind and enjoy!



WILDLIFE CITY - Fox and Bears Colorstory

Fabric and Supplies Needed

Fabric amounts based on yardage that is 42" wide.

Color	Fabric	Name/SKU	Yardage	Color	Fabric	Name/SKU	Yardage
	A	AJQD-18459-268 NATURE	2/3 yard (one full panel)		H	K001-1336 SLATE	1/8 yard
	B	ETJ-9864-184 CHARCOAL	1 yard		I	K001-1101 DELFT	1/8 yard
	C	ETJ-9864-156 LINEN	1-1/4 yard		J	K001-1058 CADET	1/8 yard
	D	K001-857 ROASTED PECAN	1/8 yard		K	K001-1389 WINDSOR	1/8 yard
	E	AJQD-18461-268 NATURE	1/4 yard		L	K001-1243 NAVY	1/8 yard
	F	K001-277 BLUEBERRY	1/8 yard		M	ETJ-9864-9 NAVY	1/4 yard
	G	K001-1123 DRESDEN BLUE	1/8 yard		Binding*	ETJ-9864-184 CHARCOAL <i>*Also used for Fabric B</i>	1/2 yard

Copyright 2018, Robert Kaufman
For individual use only - Not for resale

You will also need:
3-3/4 yards for backing