

DAISY'S RUNNER

Designed by Elise Lea for RK
www.robertkaufman.com

Featuring FLOWERHOUSE

Daisy's Bluework
A FLOWERHOUSE COLLECTION
by Debbie Beaves



Charm Square
Friendly

Finished quilt measures: 17" x 67-1/2"





Difficulty Rating: **Beginner**

ROBERTKAUFMAN
F A B R I C S

For questions about this pattern, please email Patterns@RobertKaufman.com.

Fabric and Supplies Needed

Fabric amounts based on yardage that is 42" wide.

Color	Fabric	Name/SKU	Yardage	Color	Fabric	Name/SKU	Yardage
		CHS-1096-42 DAISY'S BLUEWORK	One Charm Pack		B	FLHD-21272-9 NAVY	1/3 yard
	A	FLHD-21293-4 BLUE	1 yard		Binding*	FLHD-21272-9 NAVY <i>*Also used for Fabric B</i>	3/8 yard
<p>Copyright 2023, Robert Kaufman For individual use only - Not for resale</p>				<p>You will also need: 1-1/2 yards for backing</p>			

Notes Before You Begin

- Read through all of the instructions before beginning.
- All of the seam allowances are 1/4" unless otherwise noted.
- Press seam allowances open unless otherwise noted.
- Width of fabric (WOF) is equal to at least 42" wide.
- Right sides together has been abbreviated to RST.
- Remember to measure twice and cut once!

Cutting Instructions

Select at least thirty-two Charm Squares from your pack. Half of the squares should be light and half should be dark. From each selected square, cut:

two 2-1/2" x WOF strips. Subcut:

one-hundred and twenty-six 2-1/2" squares.

Set Fabric A aside for the Embroider the Blocks section.

From Fabric B, cut:

five 2" x WOF strips. Subcut:

eight 2" x 12-1/2" rectangles.

eight 2" x 9-1/2" rectangles.

From the Binding Fabric, cut:

five 2-1/2" x WOF strips.

Embroider the Blocks

Step 1: Embroider four different blocks from the Fabric A panel. See the Project Assembly Diagram on page 4 for the exact blocks used in the sample runner. Use blue embroidery floss, with one thread for all outline stitches; two threads for Lazy Daisy and French knot stitches.

Step 2: Hand wash and rinse the blocks after embroidering. Let dry flat. Press right side down on a towel or wool pressing mat. **Trim each block to 9-1/2" square.**

Finish the Embroidered Blocks

Step 3: Gather one Embroidered Block, two 2" x 9-1/2" Fabric B rectangles, and two 2" x 12-1/2" Fabric B rectangles. Sew the 2" x 9-1/2" rectangles to the left and right edges of the Embroidered Block, then press the seams towards the outside. Sew the 2" x 12-1/2" rectangles to the top and bottom edges of the Embroidered Block, then press the seams towards the outside. Repeat to make four Embroidered Blocks.



Finish the Pieced Blocks

Step 4: Gather twenty-one 2-1/2" squares—twelve dark squares and nine light squares—in a variety of print fabrics. Arrange the squares in six rows as shown. Alternate between lights and darks across the layout. Sew the squares together to form rows, then press the seams towards the darker squares. Align the left side of each row, nest the seams, and sew the rows together to form the block. Repeat to make six Pieced Blocks.

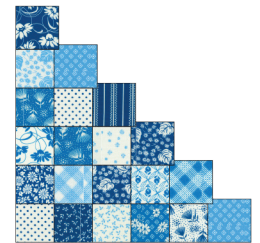

Assemble the Runner

Step 5: Arrange the Embroidered and Pieced Blocks into four rows as shown. Note the fabric placement and block orientation in the Quilt Assembly Diagram.

Step 6: Sew the blocks together to form rows. Press the seams to towards the Embroidered Blocks.

Step 7: Stagger the blocks so the points of the Embroidered Blocks nest. Sew the rows together to form the quilt center. Press the row seams open.

Step 8: Measure 1/4" past the intersection of the seams on the outer edge and trim the 2-1/2" squares to create a straight edge.

Your project top is complete! Baste, quilt, bind, and enjoy!

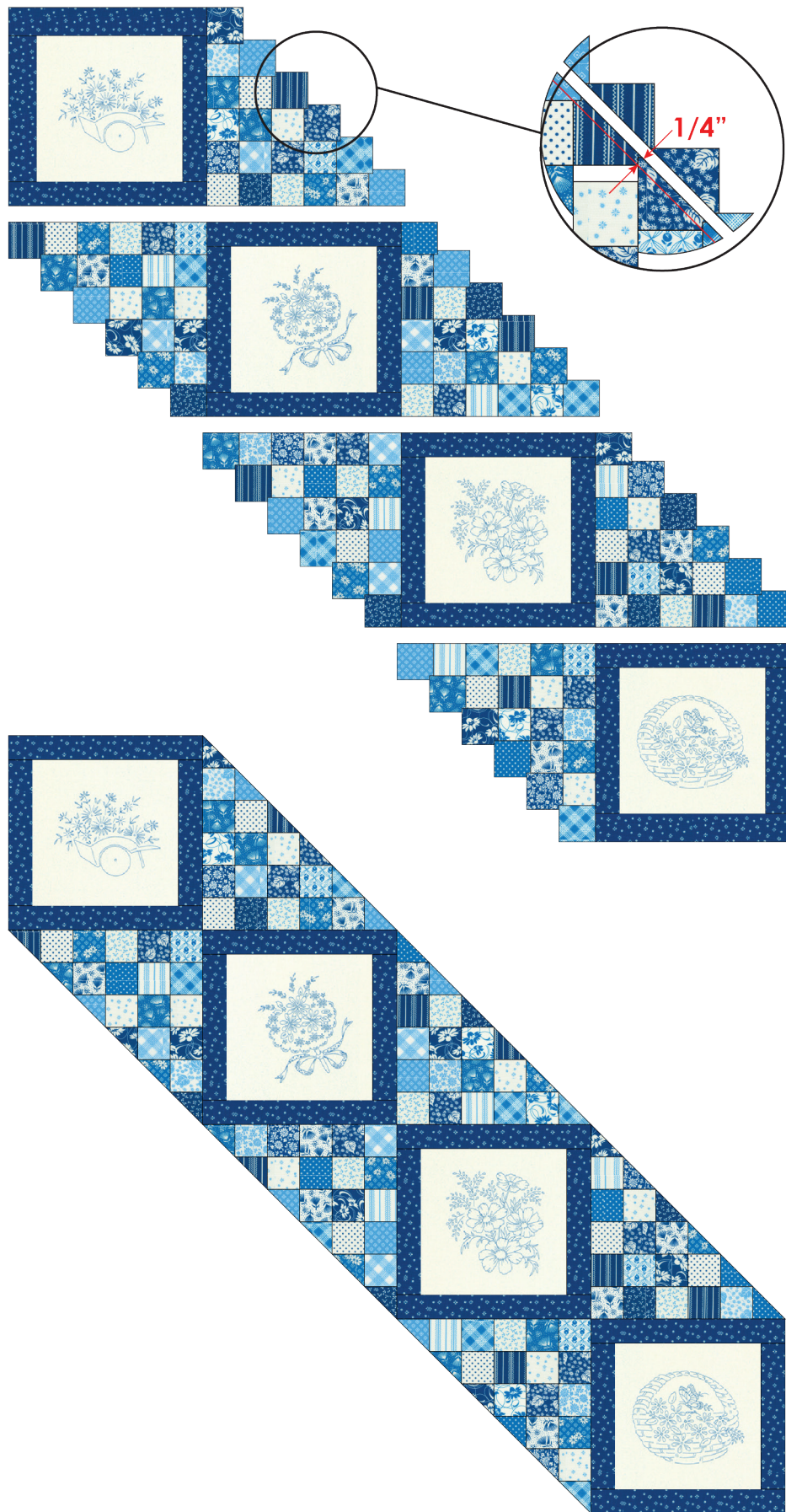

This pattern may be used for personal purposes only and may not be reproduced in any form without the express permission from Robert Kaufman Fabrics. This pattern is not for resale. All patterns, unless otherwise attributed, are © Robert Kaufman Co., Inc. 2005-2023. All rights reserved.